

OT 2090 Reducing nipples

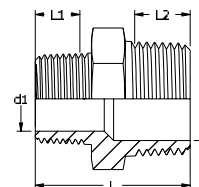

DN	Dim.	L	L1 ISO 7/1	L2 ISO 7/1	d	d1	NW	Weight kg/pce	Article code BSP-threaded EN 1.4404	Article code NPT-threaded EN 1.4404
8 x 6	1/4" x 1/8"	25.0	7.5	11.0	7.5	5.0	14	0.02	11-0209-01	11-0209-51
10 x 6	3/8" x 1/8"	25.5	7.5	11.5	10.0	5.0	19	0.03	11-0209-02	11-0209-52
10 x 8	3/8" x 1/4"	29.0	11.0	11.5	10.0	7.5	19	0.03	11-0209-03	11-0209-53
15 x 6	1/2" x 1/8"	30.0	7.5	15.0	14.0	5.0	22	0.05	11-0209-04	11-0209-54
15 x 8	1/2" x 1/4"	33.0	11.0	15.0	14.0	7.5	22	0.04	11-0209-05	11-0209-55
15 x 10	1/2" x 3/8"	33.5	11.5	15.0	14.0	10.0	22	0.05	11-0209-06	11-0209-56
20 x 8	3/4" x 1/4"	37.0	11.0	16.5	19.0	7.5	30	0.07	11-0209-07	11-0209-57
20 x 10	3/4" x 3/8"	37.0	11.5	16.5	19.0	10.0	30	0.08	11-0209-08	11-0209-58
20 x 15	3/4" x 1/2"	40.5	15.0	16.5	19.0	14.0	30	0.09	11-0209-09	11-0209-59
25 x 8	1" x 1/4"	40.0	11.0	19.0	24.5	7.5	36	0.11	11-0209-10	11-0209-60
25 x 10	1" x 3/8"	40.5	11.5	19.0	24.5	10.0	36	0.13	11-0209-11	11-0209-61
25 x 15	1" x 1/2"	44.0	15.0	19.0	24.5	14.0	36	0.12	11-0209-12	11-0209-62
25 x 20	1" x 3/4"	45.5	16.5	19.0	24.5	19.0	36	0.13	11-0209-13	11-0209-63
32 x 15	1 1/4" x 1/2"	48.0	15.0	21.5	31.0	14.0	46	0.20	11-0209-14	11-0209-64
32 x 20	1 1/4" x 3/4"	49.5	16.5	21.5	31.0	19.0	46	0.25	11-0209-15	11-0209-65
32 x 25	1 1/4" x 1"	52.0	19.0	21.5	31.0	24.5	46	0.26	11-0209-16	11-0209-66
40 x 15	1 1/2" x 1/2"	48.0	15.0	21.5	38.0	14.0	50	0.28	11-0209-17	11-0209-67
40 x 25	1 1/2" x 1"	52.0	19.0	21.5	38.0	24.5	50	0.30	11-0209-18	11-0209-68
40 x 32	1 1/2" x 1 1/4"	54.0	21.5	21.5	38.0	31.0	50	0.29	11-0209-19	11-0209-69
50 x 25	2" x 1"	59.0	19.0	25.8	49.0	24.5	65	0.50	11-0209-20	11-0209-70
50 x 32	2" x 1 1/4"	62.0	21.5	25.8	49.0	31.0	65	0.50	11-0209-21	11-0209-71
50 x 40	2" x 1 1/2"	62.0	21.5	25.8	49.0	38.0	65	0.48	11-0209-22	11-0209-72
65 x 20	2 1/2" x 3/4"	63.0	16.5	30.3	63.0	19.0	80	0.74	11-0209-23	-
65 x 50	2 1/2" x 2"	73.0	25.8	30.3	63.0	49.0	80	0.82	11-0209-24	-
80 x 50	3" x 2"	78.0	25.8	33.5	75.0	49.0	90	1.08	11-0209-25	-
80 x 65	3" x 2 1/2"	82.0	30.3	33.5	75.0	63.0	90	0.93	11-0209-26	-
40 x 20	1 1/2" x 3/4"	49.0	16.5	21.5	38.0	19.0	50	0.29	11-0209-27	-