

OT 2110 Bushings

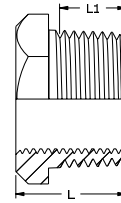

DN	Dim.	L ISO 228/1	L1 ISO 7/1	NW	Design pressure Mpa	Weight kg/pce	Article code BSP-threaded EN 1.4404	Article code NPT-threaded EN 1.4404
8 x 6	1/4" x 1/8"	17.0	11.0	14	10.0	0.02	11-0211-01	11-0211-51
10 x 6	3/8" x 1/8"	17.5	11.5	19	10.0	0.03	11-0211-02	11-0211-52
10 x 8	3/8" x 1/4"	17.5	11.5	19	10.0	0.02	11-0211-03	11-0211-53
15 x 6	1/2" x 1/8"	21.0	15.0	22	10.0	0.05	11-0211-04	11-0211-54
15 x 8	1/2" x 1/4"	21.0	15.0	22	10.0	0.04	11-0211-05	11-0211-55
15 x 10	1/2" x 3/8"	21.0	15.0	22	10.0	0.02	11-0211-06	11-0211-56
20 x 8	3/4" x 1/4"	24.5	16.5	30	10.0	0.09	11-0211-07	11-0211-57
20 x 10	3/4" x 3/8"	24.5	16.5	30	10.0	0.07	11-0211-08	11-0211-58
20 x 15	3/4" x 1/2"	24.5	16.5	30	10.0	0.05	11-0211-09	11-0211-59
25 x 8	1" x 1/4"	27.0	19.0	36	10.0	0.15	11-0211-10	11-0211-60
25 x 10	1" x 3/8"	27.0	19.0	36	10.0	0.15	11-0211-11	11-0211-61
25 x 15	1" x 1/2"	27.0	19.0	36	10.0	0.12	11-0211-12	11-0211-62
25 x 20	1" x 3/4"	27.0	19.0	36	10.0	0.07	11-0211-13	11-0211-63
32 x 15	1 1/4" x 1/2"	32.5	21.5	46	6.4	0.30	11-0211-26	-
32 x 20	1 1/4" x 3/4"	32.5	21.5	46	6.4	0.19	11-0211-14	11-0211-64
32 x 25	1 1/4" x 1"	32.5	21.5	46	6.4	0.12	11-0211-15	11-0211-65
40 x 15	1 1/2" x 1/2"	32.5	21.5	50	6.4	0.35	11-0211-16	11-0211-66
40 x 20	1 1/2" x 3/4"	32.5	21.5	50	6.4	0.36	11-0211-17	11-0211-67
40 x 25	1 1/2" x 1"	32.5	21.5	50	6.4	0.26	11-0211-18	11-0211-68
40 x 32	1 1/2" x 1 1/4"	32.5	21.5	50	6.4	0.13	11-0211-19	11-0211-69
50 x 25	2" x 1"	40.0	26.0	65	6.4	0.68	11-0211-20	11-0211-70
50 x 32	2" x 1 1/4"	40.0	26.0	65	6.4	0.52	11-0211-21	11-0211-71
50 x 40	2" x 1 1/2"	40.0	26.0	65	6.4	0.40	11-0211-22	11-0211-72
65 x 50	2 1/2" x 2"	46.0	30.0	80	4.0	0.54	11-0211-23	-
80 x 50	3" x 2"	51.5	33.5	90	4.0	1.24	11-0211-24	-
80 x 65	3" x 2 1/2"	51.5	33.5	90	4.0	0.74	11-0211-25	-