



INSTALLATIONSTECHNIK

Setzen Sie auf die Rohrleitungstechnik von ASCHL. Punkt.



ASCHL[®]

EDELSTAHL IN BESTFORM

www.aschl-edelstahl.com



... durch Kompetenz.

... durch Sicherheit. Unsere hohe Lieferfähigkeit, unser Know-how und Engagement aller Mitarbeiter geben Ihnen Sicherheit. Sie sollen wissen: Am besten wird Ihr Auftrag bei uns abgearbeitet. Keine Sorgen mehr mit Ihrem Projekt, ASCHL steht für Sicherheit.

... durch Seriosität. Sie als unser Kunde sind unser Partner, der „direkte Draht“ zu Ihnen ist uns wichtig und wertvoll. Wir nehmen uns gerne Zeit für Sie, hören Ihnen zu. Wir bauen auf Ehrlichkeit und Verlässlichkeit.

Denn Sie sollten zu jeder Zeit, in jeder Situation sicher sein können: Was ASCHL verspricht, das hält!

A handwritten signature in black ink, appearing to read 'Z. Müller'.



KUNDENBEDARF



LÖSUNGEN



PRODUKTION



QUALITÄTSTEST



AUSLIEFERUNG



INHALT INSTALLATIONSTECHNIK

GEWINDEFITTINGS

Gewindefittings PN10	6
Gewindefittings PN16	42
Gewindefittings PN40 - PN100	70

SCHNEIDERINGVERSCHRAUBUNGEN

Schneideringverschraubungen	75
-----------------------------	----

GETRÄNKLEITUNGSFITTINGS

Getränkeleitungsfitting	82
-------------------------	----

SCHLÄUCHE

Schläuche	84
-----------	----

PIPE REPAIR KIT

Pipe Repair Kit	87
-----------------	----

DIMENSIONEN

DN	6	8	10	15	20	25	32	40	50	65	80	100	125	150	200	250	300
Gewinde	1/4"	1/4"	3/8"	1/2"	3/4"	1"	5/4"	5/4"	2"	2 1/2"	3"	4"	5"	6"	8"	10"	12"
ADm. ISO	10,2	13,5	17,2	21,3	26,9	33,7	42,4	48,3	60,3	76,1	88,9	114,3	139,7	168,3	219,1	273	323,9
ADm. metrisch*			12	18	23	28	35	44	54	69/70	84	104	129	154	204	254	304

* bei 2 mm Wandstärke

ABKÜRZUNGEN

AG	Außengewinde	EPDM	Ethylen-Propylen-Dien-Kautschuk (Butyl-Kautschuk)
IG	Innengewinde	FEP	Perfluorethylenpropylen-Copolymer
EE	Einschiebeende	FKM	Fluorkautschuk (Viton)
MU	Muffe	NBR	Nitril-Butadien-Kautschuk (Perbunan)
F	Flansch	PP	Polypropylen
S	Anschweißende	PTFE	Polytetrafluorethylen (Teflon)

GEWINDENORMEN

Unsere Gewindefittings werden mit einem BSP-Gewinde ausgeliefert, außer es wird explizit eine andere Gewindenorm angegeben.

GEWINDEFITTINGS PN10

- » Material V4A (1.4408)
- » druckbeständig bis PN10 (10bar)
- » Einzelteile dürfen nicht getauscht werden



WINKEL 90° IG/IG

(wie Temperguss 90)



Dimension	Art.Nr.
1/4"	301-006K
1/4"	301-008K
3/8"	301-010K
1/2"	301-015K
3/4"	301-020K
1"	301-025K
5/4"	301-032K
5/4"	301-040K
2"	301-050K
2 1/2"	301-065K
3"	301-080K
4"	301-100K

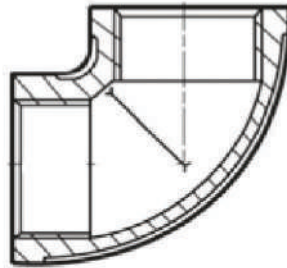

WINKEL 90° IG/IG RED.

(wie Temperguss 902)



Dimension	Art.Nr.
1/4" - 1/6"	301R-008K
3/8" - 1/4"	301R-010K
1/2" - 3/8"	301R-015K
3/4" - 1/2"	301R-020K
1" - 3/4"	301R-025K
5/4" - 1"	301R-032K
5/4" - 5/4"	301R-040K
2" - 5/4"	301R-050K

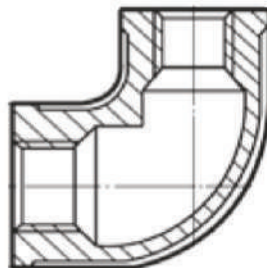

KREUZSTÜCK
(wie Temperguss 180)



Dimension	Art.Nr.
1/8"	302-006K
1/4"	302-008K
3/8"	302-010K
1/2"	302-015K
3/4"	302-020K
1"	302-025K
5/4"	302-032K
6/4"	302-040K
2"	302-050K
2 1/2"	302-065K
3"	302-080K
4"	302-100K

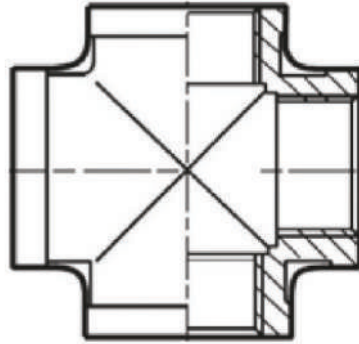

WINKEL 45° IG/IG
(wie Temperguss 120)



Dimension	Art.Nr.
1/8"	303-006K
1/4"	303-008K
3/8"	303-010K
1/2"	303-015K
3/4"	303-020K
1"	303-025K
5/4"	303-032K
6/4"	303-040K
2"	303-050K
2 1/2"	303-065K
3"	303-080K
4"	303-100K

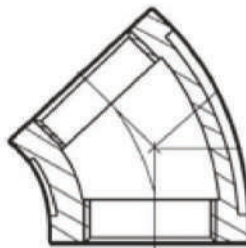

WINKEL 45° IG/AG

(wie Temperguss 40)

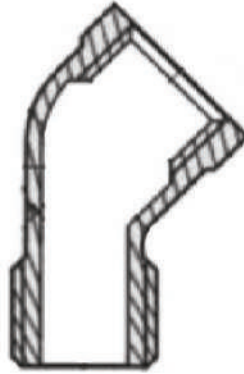

Bezeichnung	Art.Nr.
1/8"	303IA-006K
1/4"	303IA-008K
3/8"	303IA-010K
1/2"	303IA-015K
3/4"	303IA-020K
1"	303IA-025K
5/4"	303IA-032K
3/4"	303IA-040K
2"	303IA-050K
2 1/2"	303IA-065K
3"	303IA-080K
4"	303IA-100K

WINKEL 90° IG/AG

(wie Temperguss 92)

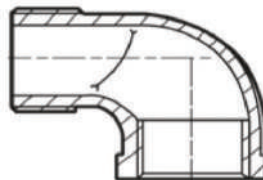

Bezeichnung	Art.Nr.
1/8"	304-006K
1/4"	304-008K
3/8"	304-010K
1/2"	304-015K
3/4"	304-020K
1"	304-025K
5/4"	304-032K
3/4"	304-040K
2"	304-050K
2 1/2"	304-065K
3"	304-080K
4"	304-100K

BOGEN 90° AG/AG

(wie Temperguss 3)



Bezeichnung	Art.Nr.
1/8"	305-006K
1/4"	305-008K
3/8"	305-010K
1/2"	305-015K
3/4"	305-020K
1"	305-025K
3/4"	305-032K
5/4"	305-040K
2"	305-050K

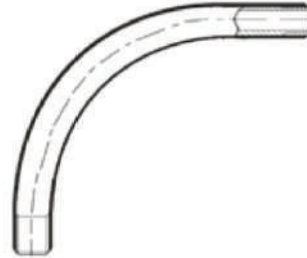

Y-STÜCK

(wie Temperguss 220)



Bezeichnung	Art.Nr.
1/8"	306-006K
1/4"	306-008K
3/8"	306-010K
1/2"	306-015K
3/4"	306-020K
1"	306-025K
3/4"	306-032K
5/4"	306-040K
2"	306-050K
2 1/2"	306-065K
3"	306-080K
4"	306-100K

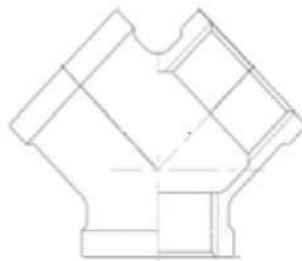

T-STÜCK IG

(wie Temperguss 130)



Bezeichnung	Art.Nr.
1/4"	307-006K
1/4"	307-008K
3/8"	307-010K
1/2"	307-015K
3/4"	307-020K
1"	307-025K
5/4"	307-032K
5/4"	307-040K
2"	307-050K
2 1/2"	307-065K
3"	307-080K
4"	307-100K

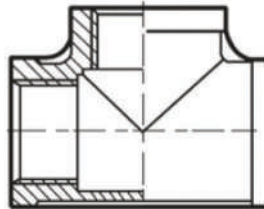

T-STÜCK RED. IG

(wie Temperguss 130R)



Bezeichnung	Art.Nr.
1/4" - 1/8" - 1/4"	307R-1-008K
3/8" - 1/4" - 3/8"	307R-1-010K
1/2" - 3/8" - 1/2"	307R-1-015K
3/4" - 1/2" - 3/4"	307R-1-020K
1" - 3/4" - 1"	307R-1-025K
5/4" - 1" - 5/4"	307R-1-032K
5/4" - 5/4" - 5/4"	307R-1-040K
2" - 5/4" - 2"	307R-1-050K

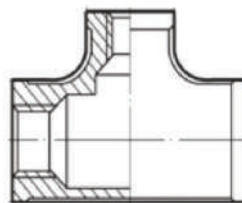

GEWINDESCHNEIDEN

Im 24h Stunden-Service

Anschweiß- und Rohrdoppelnippel.

Wir schneiden für Sie Gewindenippel in Ihrer Wunschlänge bis 6 Meter Rohrlänge, Durchmesser 1/2" – 3" möglich in V2A oder V4A.

T-STÜCK 2-STUFIG IG



Bezeichnung	Art.Nr.
1/2" - 1/4" - 1/2"	307R-2-015K
1" - 1/2" - 1"	307R-2-025K
5/4" - 1" - 5/4"	307R-2-040K
2" - 5/4" - 2"	307R-2-050K

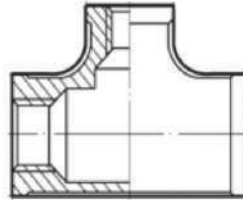

T-STÜCK 3-STUFIG IG



Bezeichnung	Art.Nr.
5/4" - 1/2" - 5/4"	307R-3-032K
5/4" - 3/4" - 5/4"	307R-3-040K
2" - 1" - 2"	307R-3-050K

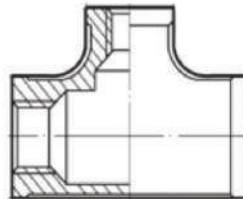

T-STÜCK RED. 4-STUFIG IG



Bezeichnung	Art.Nr.
5/4" - 1/2" - 5/4"	307R-4-040K
2" - 3/4" - 2"	307R-4-050K

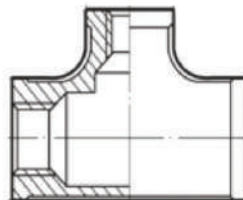

ANSCHWEISSNIPPEL

(wie Temperguss 533)



Bezeichnung	Art.Nr.
1/8"	308-006K
1/4"	308-008K
3/8"	308-010K
1/2"	308-015K
3/4"	308-020K
1"	308-025K
5/4"	308-032K
5/4"	308-040K
2"	308-050K
2 1/2"	308-065K
3"	308-080K
4"	308-100K

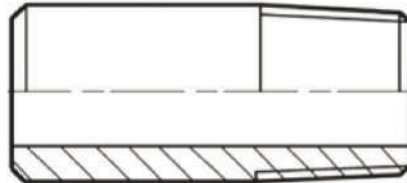

ROHRNIPPEL

(wie Temperguss 531)



Bezeichnung	Art.Nr.
1/8"	309-006K
1/4"	309-008K
3/8"	309-010K
1/2"	309-015K
3/4"	309-020K
1"	309-025K
5/4"	309-032K
5/4"	309-040K
2"	309-050K
2 1/2"	309-065K
3"	309-080K
4"	309-100K

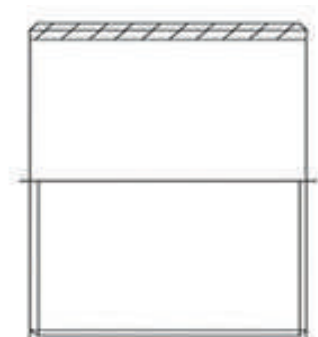

ROHRDOPPELNIPPEL AG/AG

(wie Temperguss 530)

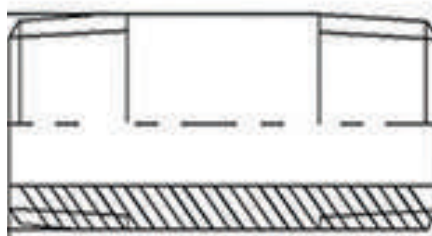

Bezeichnung	Art.Nr.
1/8"	310-006K
1/4"	310-008K
3/8"	310-010K
1/2"	310-015K
3/4"	310-020K
1"	310-025K
5/4"	310-032K
3/4"	310-040K
2"	310-050K
2 1/2"	310-065K
3"	310-080K
4"	310-100K

VERSCHR. IG/IG FLACH

(wie Temperguss 330)

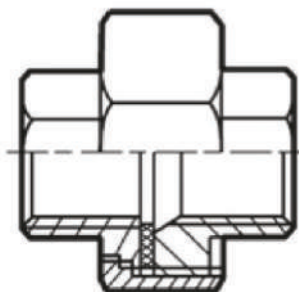

Bezeichnung	Art.Nr.
1/8"	311-006K
1/4"	311-008K
3/8"	311-010K
1/2"	311-015K
3/4"	311-020K
1"	311-025K
5/4"	311-032K
3/4"	311-040K
2"	311-050K
2 1/2"	311-065K
3"	311-080K
4"	311-100K

VERSCHR. IG/IG KON.

(wie Temperguss 340)



Bezeichnung	Art.Nr.
1/8"	312-006K
1/4"	312-008K
3/8"	312-010K
1/2"	312-015K
3/4"	312-020K
1"	312-025K
5/8"	312-032K
3/4"	312-040K
2"	312-050K
2 1/2"	312-065K
3"	312-080K
4"	312-100K

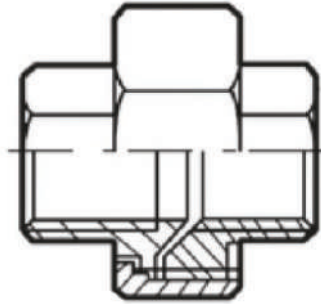

VERSCHR. AG/AG FLACH

(wie Temperguss 336)



Bezeichnung	Art.Nr.
1/8"	311AGA-006K
1/4"	311AGA-008K
3/8"	311AGA-010K
1/2"	311AGA-015K
3/4"	311AGA-020K
1"	311AGA-025K
5/8"	311AGA-032K
3/4"	311AGA-040K
2"	311AGA-050K
2 1/2"	311AGA-065K
3"	311AGA-080K
4"	311AGA-100K

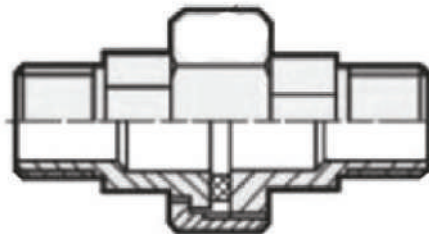

VERSCHR. AG/AG KON.

(wie Temperguss 344)



Bezeichnung	Art.Nr.
1/6"	312AGA-006K
1/4"	312AGA-008K
3/8"	312AGA-010K
1/2"	312AGA-015K
3/4"	312AGA-020K
1"	312AGA-025K
5/4"	312AGA-032K
3/4"	312AGA-040K
2"	312AGA-050K
2 1/2"	312AGA-065K
3"	312AGA-080K
4"	312AGA-100K

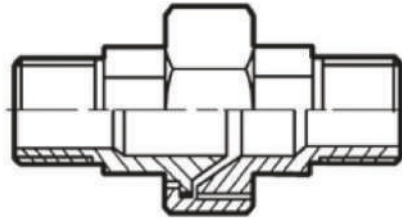

WINKELVERSCHR. IG/IG FLACH

(wie Temperguss 95)



Bezeichnung	Art.Nr.
1/6"	311W-006K
1/4"	311W-008K
3/8"	311W-010K
1/2"	311W-015K
3/4"	311W-020K
1"	311W-025K
5/4"	311W-032K
3/4"	311W-040K
2"	311W-050K

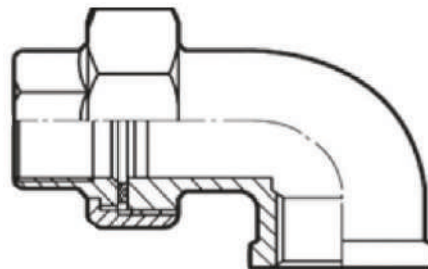

WINKELVERSCHR. IG/IG KON.

(wie Temperguss 96)



Bezeichnung	Art.Nr.
1/4"	312W-008K
3/8"	312W-010K
1/2"	312W-015K
3/4"	312W-020K
1"	312W-025K
5/4"	312W-032K
5/4"	312W-040K
2"	312W-050K

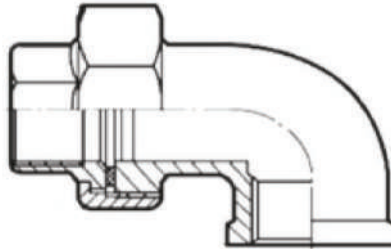

WINKELVERSCHR. IG/AG FLACH

(wie Temperguss 97)



Bezeichnung	Art.Nr.
1/4"	311WIA-008K
3/8"	311WIA-010K
1/2"	311WIA-015K
3/4"	311WIA-020K
1"	311WIA-025K
5/4"	311WIA-032K
5/4"	311WIA-040K
2"	311WIA-050K

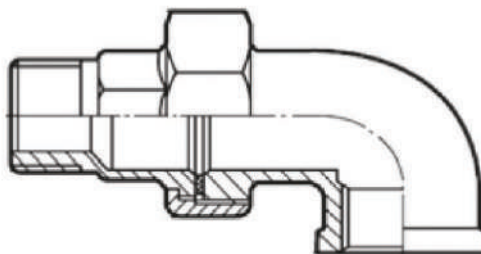

WINKELVERCHR. IG/AG KON.

(wie Temperguss 98)



Bezeichnung	Art.Nr.
1/4"	312WIA-008K
3/8"	312WIA-010K
1/2"	312WIA-015K
3/4"	312WIA-020K
1"	312WIA-025K
5/4"	312WIA-032K
5/4"	312WIA-040K
2"	312WIA-050K

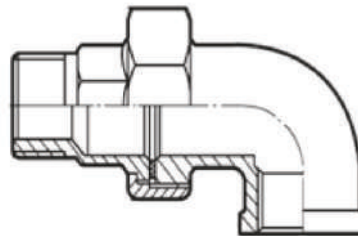

VERCHR. AE/AE KON.

(wie Temperguss 342)



Bezeichnung	Art.Nr.
1/8"	313-006K
1/4"	313-008K
3/8"	313-010K
1/2"	313-015K
3/4"	313-020K
1"	313-025K
5/4"	313-032K
5/4"	313-040K
2"	313-050K
2 1/2"	313-065K
3"	313-080K
4"	313-100K

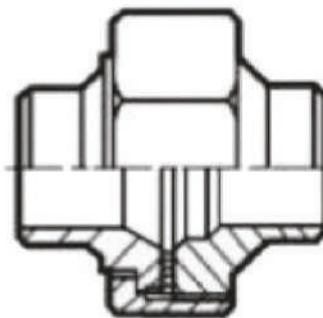

VERSCHR. AE/AE FLACH

(wie Temperguss 332)

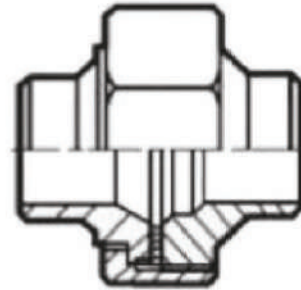

Bezeichnung	Art.Nr.
1/8"	314-006K
1/4"	314-008K
3/8"	314-010K
1/2"	314-015K
3/4"	314-020K
1"	314-025K
5/4"	314-032K
3/4"	314-040K
2"	314-050K
2 1/2"	314-065K
3"	314-080K
4"	314-100K

VERSCHR. IG/AG KON.

(wie Temperguss 341)

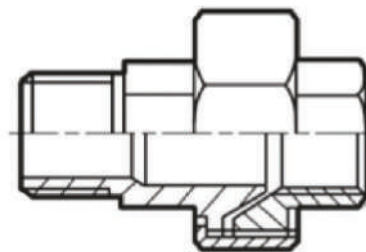

Bezeichnung	Art.Nr.
1/8"	315-006K
1/4"	315-008K
3/8"	315-010K
1/2"	315-015K
3/4"	315-020K
1"	315-025K
5/4"	315-032K
3/4"	315-040K
2"	315-050K
2 1/2"	315-065K
3"	315-080K
4"	315-100K

VERSCHR. IG/AG FLACH

(wie Temperguss 331)

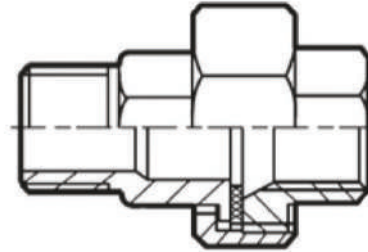

Bezeichnung	Art.Nr.
1/8"	316-006K
1/4"	316-008K
3/8"	316-010K
1/2"	316-015K
3/4"	316-020K
1"	316-025K
5/8"	316-032K
3/4"	316-040K
2"	316-050K
2 1/2"	316-065K
3"	316-080K
4"	316-100K

VERSCHR. AE/AG FLACH

(wie Temperguss 333)

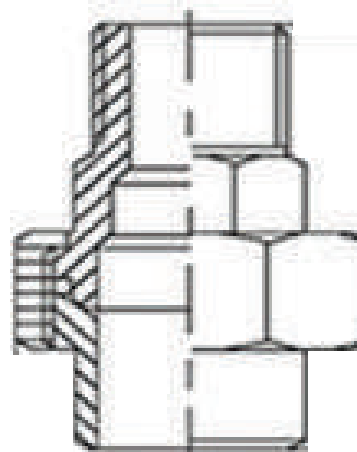

Bezeichnung	Art.Nr.
1/8"	317-006K
1/4"	317-008K
3/8"	317-010K
1/2"	317-015K
3/4"	317-020K
1"	317-025K
5/8"	317-032K
3/4"	317-040K
2"	317-050K
2 1/2"	317-065K
3"	317-080K
4"	317-100K

VERSCHR. AE/AG KON.

(wie Temperguss 343)



Bezeichnung	Art.Nr.
1/4"	318-006K
1/4"	318-008K
3/8"	318-010K
1/2"	318-015K
3/4"	318-020K
1"	318-025K
3/4"	318-032K
5/4"	318-040K
2"	318-050K
2 1/2"	318-065K
3"	318-080K

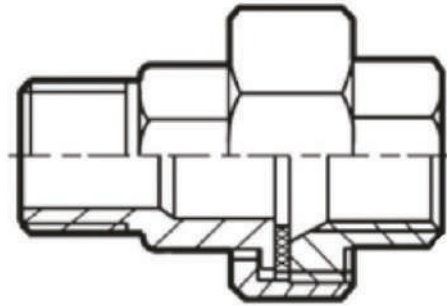

VERSCHR. AE/IG KON.

(wie Temperguss 333)



Bezeichnung	Art.Nr.
3/4"	319-010K
1/2"	319-015K
3/4"	319-020K
1"	319-025K
5/4"	319-032K
5/4"	319-040K
2"	319-050K
2 1/2"	319-065K
3"	319-080K

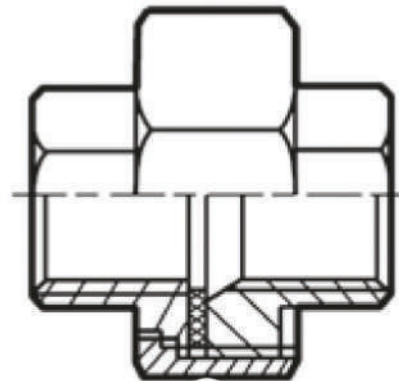

VERSCHR. AE/IG FLACH

(wie Temperguss 343)

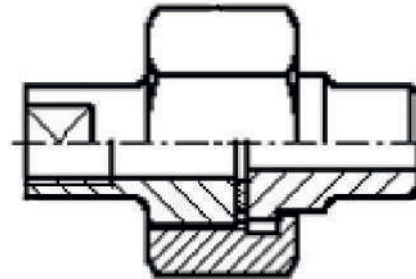

Bezeichnung (Rp)	Art.Nr.
3/8"	320-010K
1/2"	320-015K
3/4"	320-020K
1"	320-025K
5/4"	320-032K
5/4"	320-040K
2"	320-050K
2 1/2"	320-065K
3"	320-080K

RED.-STÜCK 6-KNT.

(wie Temperguss 241)

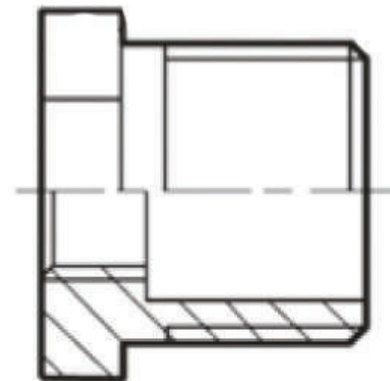

Bezeichnung	Art.Nr.
1/4" - 1/8"	325-1-008-1/4K
3/8" - 1/4"	325-1-010-3/8K
1/2" - 3/8"	325-1-015-1/2K
3/4" - 1/2"	325-1-020-3/4K
1" - 3/4"	325-1-025-1K
5/4" - 1"	325-1-032-5/4K
5/4" - 5/4"	325-1-040-6/4K
2" - 5/4"	325-1-050-2K
2 1/2" - 2"	325-1-065-21/2K
3" - 2 1/2"	325-1-080-3K
4" - 3"	325-1-100-4K

RED.-STÜCK 6-KNT. 2-STUFIG

(wie Temperguss 241-2)



Bezeichnung	Art.Nr.
3/8" - 1/8"	325-2-010-3/8K
1/2" - 1/4"	325-2-015-1/2K
3/4" - 3/8"	325-2-020-3/4K
1" - 1/2"	325-2-025-1K
5/4" - 3/4"	325-2-032-5/4K
5/4" - 1"	325-2-040-6/4K
2" - 3/4"	325-2-050-2K
2 1/2" - 5/4"	325-2-065-21/2K
3" - 2"	325-2-080-3K
4" - 2 1/2"	325-2-100-4K

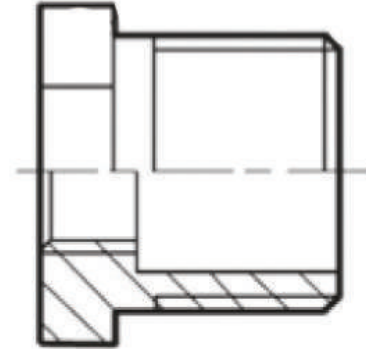

RED.-STÜCK 6-KNT. 3-STUFIG

(wie Temperguss 241)



Bezeichnung	Art.Nr.
1/2" - 1/8"	325-3-015-1/2K
3/4" - 1/4"	325-3-020-3/4K
1" - 3/8"	325-3-025-1K
5/4" - 1/2"	325-3-032-5/4K
5/4" - 3/4"	325-3-040-6/4K
2" - 1"	325-3-050-2K
2 1/2" - 5/4"	325-3-065-21/2K
3" - 5/4"	325-3-080-3K
4" - 2"	325-3-100-4K

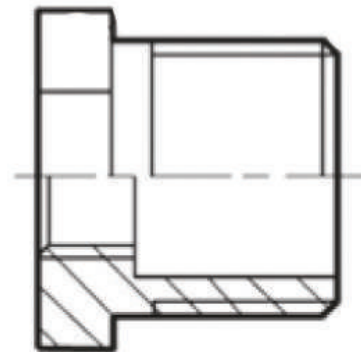
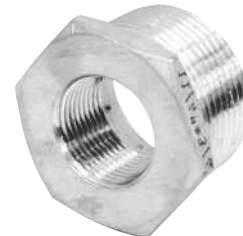

RED.-STÜCK 6-KNT. 4-STUFIG
(wie Temperguss 241-4)



Bezeichnung	Art.Nr.
3/4" - 1/6"	325-4-020-3/4K
1" - 1/4"	325-4-025-1K
5/4" - 3/6"	325-4-032-5/4K
5/4" - 1/2"	325-4-040-6/4K
2" - 3/4"	325-4-050-2K
2 1/2" - 1"	325-4-065-21/2K
3" - 5/4"	325-4-080-3K

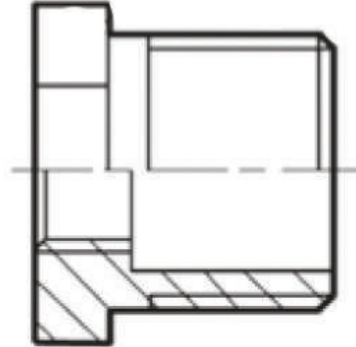

RED.-STÜCK 6-KNT. 5-STUFIG
(wie Temperguss 241-5)



Bezeichnung	Art.Nr.
1" - 1/6"	325-5-025-1K
5/4" - 3/6"	325-5-040-6/4K
2" - 1/2"	325-5-050-2K
2 1/2" - 3/4"	325-5-065-21/2K

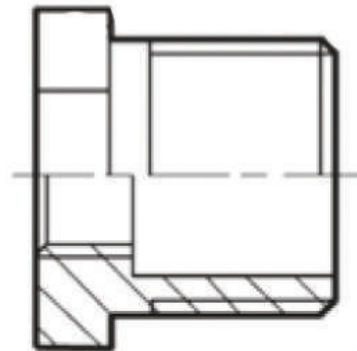

KAPPE 6-KNT.
(wie Temperguss 300)



Bezeichnung	Art.Nr.
1/8"	326-006K
1/4"	326-008K
3/8"	326-010K
1/2"	326-015K
3/4"	326-020K
1"	326-025K
5/8"	326-032K
3/4"	326-040K
2"	326-050K
2 1/2"	326-065K
3"	326-080K
4"	326-100K

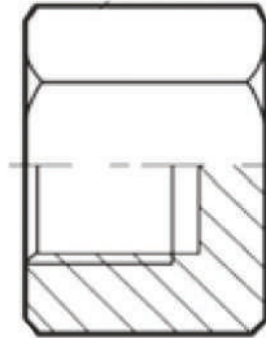

MUTTER 6-KNT.
(wie Temperguss 310)



Bezeichnung	Art.Nr.
1/8"	327-006K
1/4"	327-008K
3/8"	327-010K
1/2"	327-015K
3/4"	327-020K
1"	327-025K
5/8"	327-032K
3/4"	327-040K
2"	327-050K
2 1/2"	327-065K
3"	327-080K
4"	327-100K



MUTTER 6-KNT. (DIN 431)



Bezeichnung	Art.Nr.
1/8"	327-006-DIN431
1/4"	327-008-DIN431
3/8"	327-010-DIN431
1/2"	327-015-DIN431
3/4"	327-020-DIN431
1"	327-025-DIN431
5/4"	327-032-DIN431
3/4"	327-040-DIN431
2"	327-050-DIN431
2 1/2"	327-065-DIN431
3"	327-080-DIN431
4"	327-100-DIN431



STOPFEN 4-KNT.

(wie Temperguss 291)



Bezeichnung	Art.Nr.
1/8"	329-006K
1/4"	329-008K
3/8"	329-010K
1/2"	329-015K
3/4"	329-020K
1"	329-025K
5/4"	329-032K
3/4"	329-040K
2"	329-050K
2 1/2"	329-065K
3"	329-080K
4"	329-100K

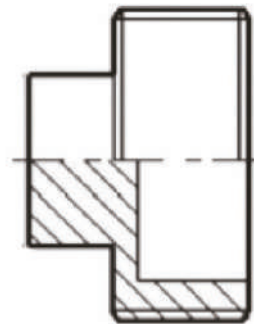

STOPFEN 6-KNT.

(wie Temperguss 290)



Bezeichnung	Art.Nr.
1/4"	330-006K
1/4"	330-008K
3/8"	330-010K
1/2"	330-015K
3/4"	330-020K
1"	330-025K
3/4"	330-0032K
5/4"	330-040K
2"	330-050K
2 1/2"	330-065K
3"	330-080K
4"	330-100K

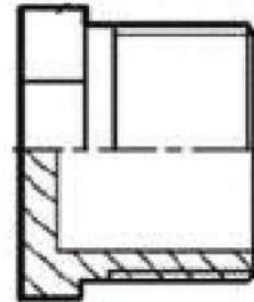

VERSCHLUSSSCHRAUBE



Bezeichnung	Art.Nr.
1/6"	331-006K
1/4"	331-008K
3/8"	331-010K
1/2"	331-015K
3/4"	331-020K
1"	331-025K
3/4"	331-032K
5/4"	331-040K
2"	331-050K

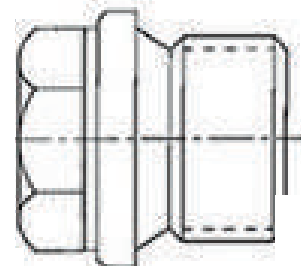

MUFFE

(wie Temperguss 270)



Bezeichnung	Art.Nr.
1/8"	333-006K
1/4"	333-008K
3/8"	333-010K
1/2"	333-015K
3/4"	333-020K
1"	333-025K
5/8"	333-032K
3/4"	333-040K
2"	333-050K
2 1/2"	333-065K
3"	333-080K
4"	333-100K



MUFFE NPT-GEWINDE

(wie Temperguss 271NPT)



Bezeichnung	Art.Nr.
1/8"	333-NPT-006K
1/4"	333-NPT-008K
3/8"	333-NPT-010K
1/2"	333-NPT-015K
3/4"	333-NPT-020K
1"	333-NPT-025K
5/8"	333-NPT-032K
3/4"	333-NPT-040K
2"	333-NPT-050K

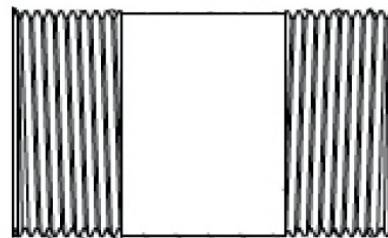

HALBE MUFFE

(wie Temperguss 270H)



Bezeichnung	Art.Nr.
1/8"	334-006K
1/4"	334-008K
3/8"	334-010K
1/2"	334-015K
3/4"	334-020K
1"	334-025K
5/8"	334-032K
3/4"	334-040K
2"	334-050K
2 1/2"	334-065K
3"	334-080K
4"	334-100K

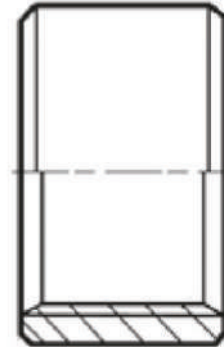

MUFFE RED. 1-STUFIG

(wie Temperguss 240)



Bezeichnung	Art.Nr.
1/4" - 1/8"	335-1-008K
3/8" - 1/4"	335-1-010K
1/2" - 3/8"	335-1-015K
3/4" - 1/2"	335-1-020K
1" - 3/4"	335-1-025K
5/4" - 1"	335-1-032K
5/4" - 3/4"	335-1-040K
2" - 5/4"	335-1-050K
2 1/2" - 2"	335-1-065K
3" - 2 1/2"	335-1-080K
4" - 3"	335-1-100K

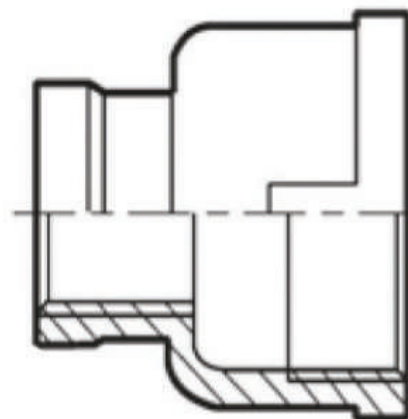

MUFFE RED. 2-STUFIG

(wie Temperguss 240-2)



Bezeichnung	Art.Nr.
3/8" - 1/8"	335-2-010K
1/2" - 1/4"	335-2-015K
3/4" - 3/8"	335-2-020K
1" - 1/2"	335-2-025K
5/4" - 3/4"	335-2-032K
5/4" - 1"	335-2-040K
2" - 3/4"	335-2-050K
2 1/2" - 5/4"	335-2-065K
3" - 2"	335-2-080K
4" - 2 1/2"	335-2-100K

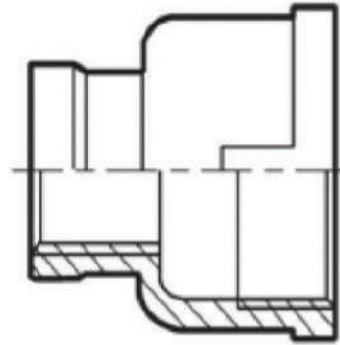

MUFFE RED. 3-STUFIG

(wie Temperguss 240-3)



Bezeichnung	Art.Nr.
1/2" - 1/8"	335-3-015K
3/4" - 1/4"	335-3-020K
1" - 3/8"	335-3-025K
5/4" - 1/2"	335-3-032K
5/4" - 3/4"	335-3-040K
2" - 1"	335-3-050K
2 1/2" - 5/4"	335-3-065K
3" - 5/4"	335-3-080K
4" - 2"	335-3-100K

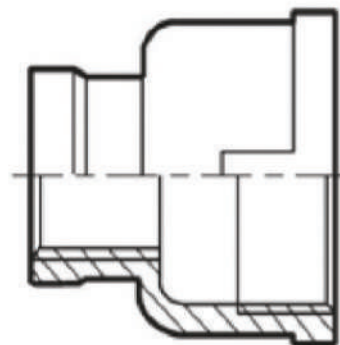

MUFFE RED. 4-STUFIG

(wie Temperguss 240-4)

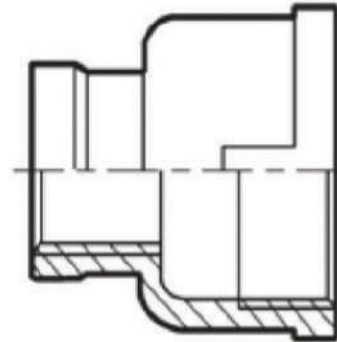

Bezeichnung	Art.Nr.
3/4" - 1/8"	335-4-020K
1" - 1/4"	335-4-025K
5/4" - 3/8"	335-4-032K
5/4" - 1/2"	335-4-040K
2" - 3/4"	335-4-050K

SCHLAUCHTÜLLE AG

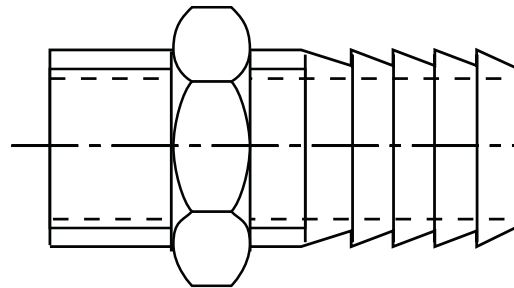

Bezeichnung	Art.Nr.
1/8"	337-006-1/8K
1/4"	337-008-1/4K
3/8"	337-010-3/8K
1/2"	337-015-1/2K
3/4"	337-020-3/4K
1"	337-025-1K
5/4"	337-032-5/4K
5/4"	337-040-6/4K
2"	337-050-2K
2 1/2"	337-065-21/2K
3"	337-080-3K

SCHLAUCHTÜLLE AG



Bezeichnung	Art.Nr.
1/4"	337-008-1/4-06mmK
1/4"	337-008-1/4K-09mmK
1/4"	337-008-1/4-11mmK
3/8"	337-010-3/8-09mmK
3/8"	337-010-3/8-13mmK
1/2"	337-015-1/2-13mmK
1/2"	337-015-1/2-15mmK
1/2"	337-015-1/2-19mmK
3/4"	337-020-3/4-16mmK
1"	337-025-1-20mmK

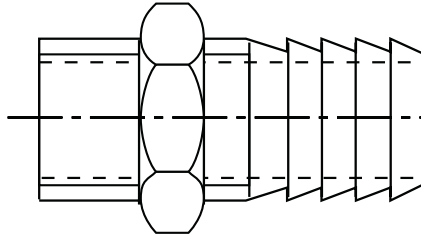

SCHLAUCHTÜLLE IG



Bezeichnung	Art.Nr.
1/6"	337IG-006-1/8K
1/4"	337IG-008-1/4K
3/8"	337IG-010-3/8K
1/2"	337IG-015-1/2K
3/4"	337IG-020-3/4K
1"	337IG-025-1K
5/4"	337IG-032-5/4K
5/4"	337IG-040-6/4K
2"	337IG-050-2K

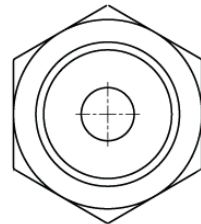
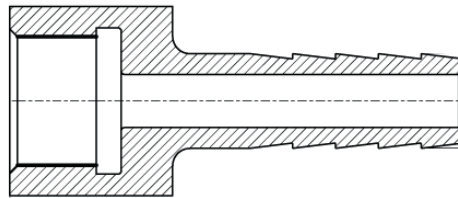

SCHLAUCHNIPPEL AG



Bezeichnung (A)	Art.Nr.
1/8"	337G-006K
1/4"	337G-008K
3/8"	337G-010K
1/2"	337G-015K
3/4"	337G-020K
1"	337G-025K
5/4"	337G-032K
3/4"	337G-040K
2"	337G-050K
2 1/2"	337G-065K
3"	337G-080K
4"	337G-100K

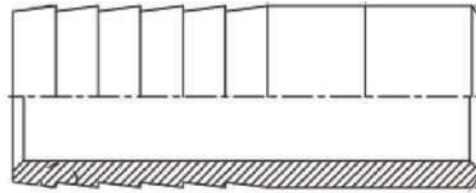

SCHLAUCHNIPPEL AE



Bezeichnung	Art.Nr.
1/8"	337S-006K
1/4"	337S-008K
3/8"	337S-010K
1/2"	337S-015K
3/4"	337S-020K
1"	337S-025K
5/4"	337S-032K
3/4"	337S-040K
2"	337S-050K
2 1/2"	337S-065K
3"	337S-080K
4"	337S-100K

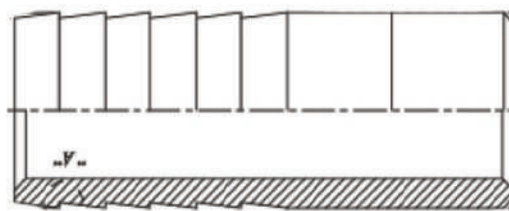

DOPPELNIPPEL 6-KNT.

(wie Temperguss 280)

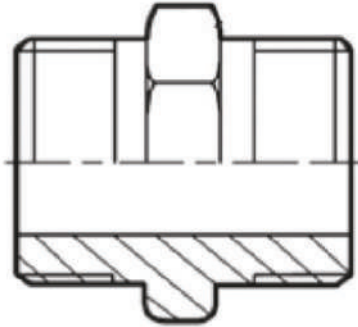

Bezeichnung	Art.Nr.
1/4"	340-006K
1/4"	340-008K
3/8"	340-010K
1/2"	340-015K
3/4"	340-020K
1"	340-025K
5/4"	340-032K
5/4"	340-040K
2"	340-050K
2 1/2"	340-065K
3"	340-080K
4"	340-100K

**DOPPELNIPPEL 6-KNT. RED.
1-STUFIG**

(wie Temperguss 245)

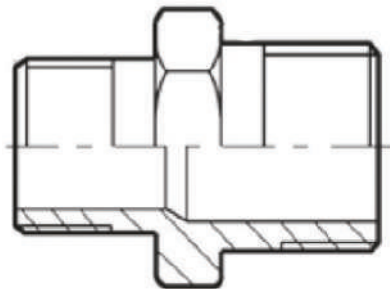

Bezeichnung	Art.Nr.
1/4" - 1/8"	341-1-008K
3/8" - 1/4"	341-1-010K
1/2" - 3/8"	341-1-015K
3/4" - 1/2"	341-1-020K
1" - 3/4"	341-1-025K
5/4" - 1"	341-1-032K
5/4" - 5/4"	341-1-040K
2" - 5/4"	341-1-050K
2 1/2" - 2"	341-1-065K
3" - 2 1/2"	341-1-080K
4" - 3"	341-1-100K

WINKEL MIT WANDSCHEIBE



Bezeichnung	Art.Nr.
1/2" 90°	301WS
1/2" 45°	303WS

DOPPELNIPPEL 6-KNT. RED. 2-STUFIG

(wie Temperguss 245-2)



Bezeichnung	Art.Nr.
3/8" - 1/4"	341-2-010K
1/2" - 1/4"	341-2-015K
3/4" - 3/8"	341-2-020K
1" - 1/2"	341-2-025K
5/4" - 3/4"	341-2-032K
5/4" - 1"	341-2-040K
2" - 5/4"	341-2-050K
2 1/2" - 5/4"	341-2-065K
3" - 2"	341-2-080K

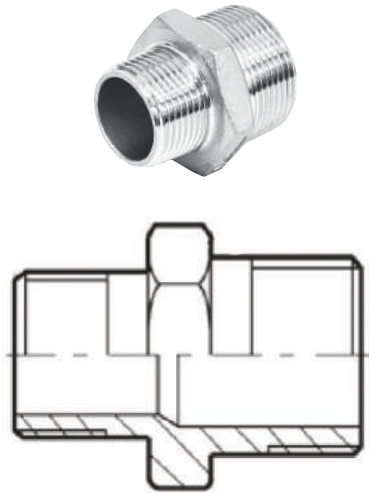

DOPPELNIPPEL 6-KNT. RED. 3-STUFIG

(wie Temperguss 245-3)



Bezeichnung	Art.Nr.
1/2" - 1/4"	341-3-015K
3/4" - 1/4"	341-3-020K
1" - 3/8"	341-3-025K
1 1/4" - 1/2"	341-3-032K
1 1/2" - 3/4"	341-3-040K
2" - 1"	341-3-050K
2 1/2" - 1 1/4"	341-3-065K

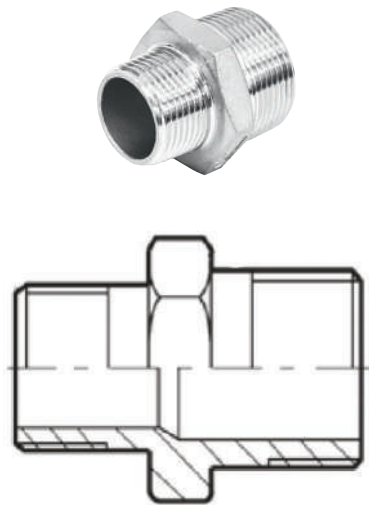

DOPPELNIPPEL 6-KNT RED. 4-STUFIG

(wie Temperguss 245-4)



Bezeichnung	Art.Nr.
1" - 1/4"	341-4-025K
1 1/2" - 1/2"	341-4-040K

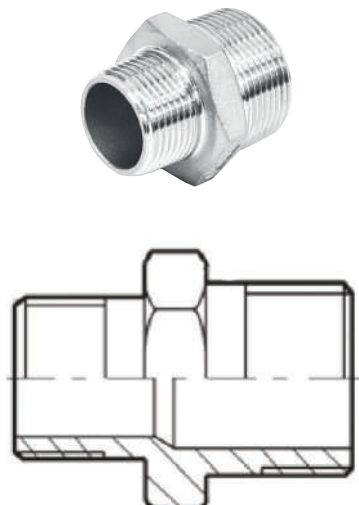

MUFFENNIPPEL IG/AG

(wie Temperguss 246)



Bezeichnung	Art.Nr.
1/4"	342-008-1/4K
3/8"	342-010-3/8K
1/2"	342-015-1/2K
3/4"	342-020-3/4K
1"	342-025-1K
5/4"	342-032-5/4K
3/4"	342-040-6/4K
2"	342-050-2K

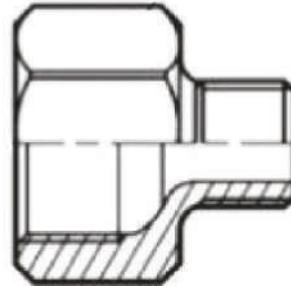

MUFFENNIPPEL IG/AG RED. 1-STUFIG

(wie Temperguss 246-1)



Bezeichnung	Art.Nr.
1/4" - 1/8"	342-1-008K
3/8" - 1/4"	342-1-010K
1/2" - 3/8"	342-1-015K
3/4" - 1/2"	342-1-020K
1" - 3/4"	342-1-025K
5/4" - 1"	342-1-032K
3/4" - 5/4"	342-1-040K
2" - 5/4"	342-1-050K

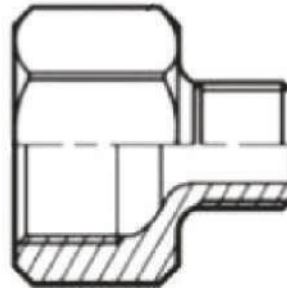

MUFFENNIPPEL IG/AG RED. 2-STUFIG

(wie Temperguss 246-2)



Bezeichnung	Art.Nr.
1/2" - 1/4"	342-2-015K
3/4" - 3/8"	342-2-020K
1" - 1/2"	342-2-025K
5/4" - 3/4"	342-2-032K
3/4" - 1"	342-2-040K

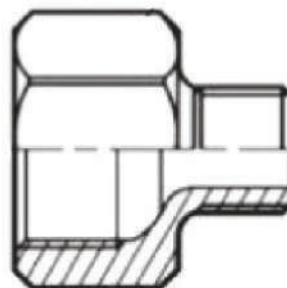

PUMPENVERSCHRAUBUNG

Material: V4A
inkl. Dichtung: C-4300

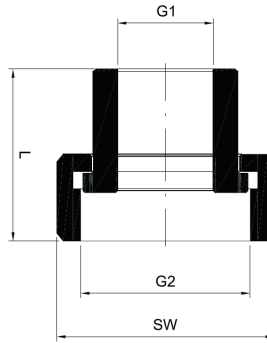
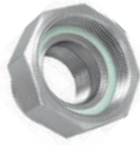

DN	Art.Nr.
3/4" x 3/4"	PVSR-020/032
3/4" x 1/2"	PVSR-020/040
1" x 3/4"	PVSR-025/040
1" x 2"	PVSR-025/050
3/4" x 2"	PVSR-032/050

PUMPENVERSCHRAUBUNG EASY

Material: V4A
inkl. Dichtung: C-4300

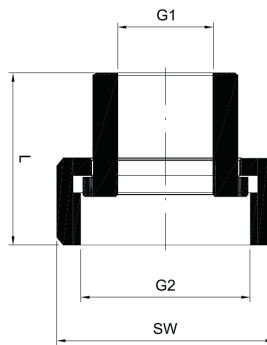

DN	Art.Nr.
3/4" x 3/4"	PVSRE-020/032-PN10
3/4" x 1/2"	PVSRE-020/040-PN10
1" x 3/4"	PVSRE-025/040-PN10
1" x 2"	PVSRE-025/050-PN10
3/4" x 2"	PVSRE-032/050-PN10

GEWINDEVERLÄNGERUNG

Material: V4A



DN	Art.Nr.	VL	GL	Ø
IG 1/2" - AG 1/2"	343-015-010	10 mm	21 mm	27 mm
IG 1/2" - AG 1/2"	343-015-015	15 mm	26 mm	27 mm
IG 1/2" - AG 1/2"	343-015-020	20 mm	31 mm	27 mm
IG 1/2" - AG 1/2"	343-015-025	25 mm	36 mm	27 mm
IG 1/2" - AG 1/2"	343-015-030	30 mm	41 mm	27 mm
IG 1/2" - AG 1/2"	343-015-040	40 mm	51 mm	27 mm
IG 1/2" - AG 1/2"	343-015-050	50 mm	61 mm	27 mm
IG 1/2" - AG 1/2"	343-015-100	100 mm	111 mm	27 mm

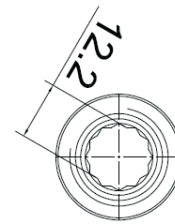
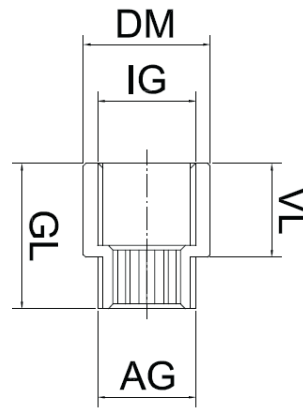

GEWINDEVERLÄNGERUNG

Material: V4A



DN	Art.Nr.	VL	GL	Ø
IG 3/4" - AG 3/4"	343-020-010	10 mm	21 mm	32 mm
IG 3/4" - AG 3/4"	343-020-015	15 mm	26 mm	32 mm
IG 3/4" - AG 3/4"	343-020-020	20 mm	31 mm	32 mm
IG 3/4" - AG 3/4"	343-020-025	25 mm	36 mm	32 mm
IG 3/4" - AG 3/4"	343-020-030	30 mm	41 mm	32 mm
IG 3/4" - AG 3/4"	343-020-040	40 mm	51 mm	32 mm
IG 3/4" - AG 3/4"	343-020-050	50 mm	61 mm	32 mm
IG 3/4" - AG 3/4"	343-020-100	100 mm	111 mm	32 mm

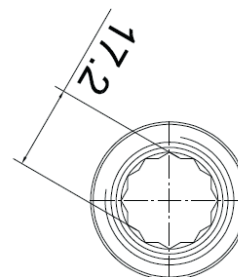
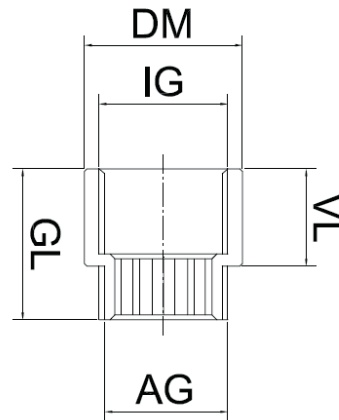

BRUNNENROHRE

Material: V2A/ V4A,
Herstellungslänge: 6 m
beiderseits Gewinde R nach DIN2999

DN	AD x Wandstärke	Gewicht
15	21,3 x 2,6 mm	1,22 kg/m
20	26,9 x 2,6 mm	1,60 kg/m
25	33,7 x 3,2 mm	2,45 kg/m
32	42,4 x 3,2 mm	3,14 kg/m
40	48,3 x 3,2 mm	3,62 kg/m
50	60,3 x 3,6 mm	5,10 kg/m
65	76,1 x 3,6 mm	6,54 kg/m
80	88,9 x 4,0 mm	8,51 kg/m



DN	1000mm	2000 mm	3000mm	6000mm
1/2"	✓	✓	✓	✓
3/4"	✓	✓	✓	✓
1"	✓	✓	✓	✓
5/4"	✓	✓	✓	✓
5/4"	✓	✓	✓	✓
2"	✓	✓	✓	✓
2 1/2"	✓	✓	✓	✓
3"	✓	✓	✓	✓

GEWINDESCHNEIDEN

- Anschweiß- und Rohrdoppelnippel
- wir schneiden für Sie Gewindenippel in Ihrer Wunschlänge bis 6 Meter Rohrlänge
- Durchmesser 1/2" – 3" möglich
- in V2A oder V4A

Im 24 Stunden-Service

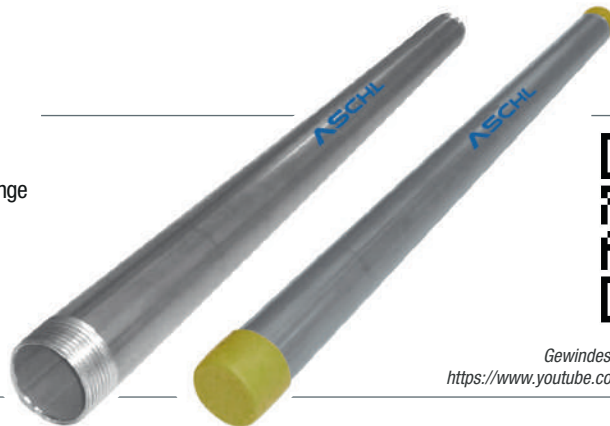

Gewindeschneiden ASCHL - YouTube
<https://www.youtube.com/watch?v=gkvznoaCM6c>

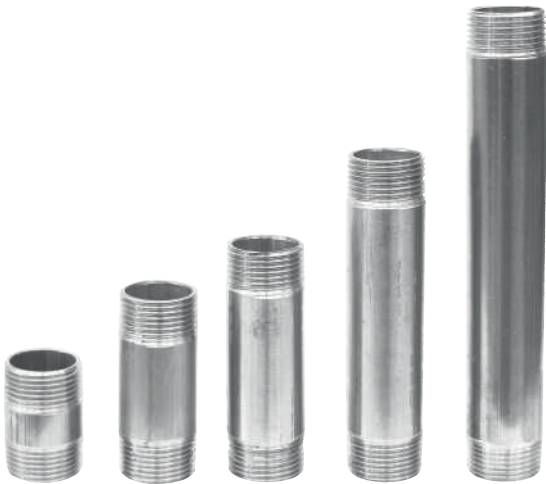

ROHRDOPPELNIPPEL SONDERLÄNGEN

Art.Nr.: 310SL

Material: V4A, PN10 (150 lbs)



ANSCHWEISSNIPPEL SONDERLÄNGEN

Art.Nr.: 308SL

Material: V4A, PN10 (150 lbs)

Sofort ab Lager

Standardlängen

Lieferzeit: 2 Wochen

GEWINDEKLEBER MITTELFEST

Gewindekleber mittelfest, Rohr- und Flächendichtung mit PTFE, mittelfest, normal demontierbar, DVGW-KTW-geprüft, Gewindegröße: max. 3", Temperatur -60°C bis +150°C, 50 ml



Menge	Art.Nr.
50 ml	045185

GEWINDEKLEBER HOCHFEST

Rohr- und Flächendichtung mit PTFE, hochfest, schwer demontierbar, Gewindegröße: max. 1 1/2" Temperatur -60°C bis +180°C, 50 ml



Menge	Art.Nr.
50 ml	045186

GEWINDE-DICHTFADEN

für Metall- und Kunststoffgewinde, aus 100% PTFE, Temperatur -200°C bis +240°C, DVGW-Gas-Zulassung, KTW-Zulassung, Gleitmittel in Dosenboden, 175 m



TEFLONBAND



Länge	Art.Nr.
12,2 m	045187

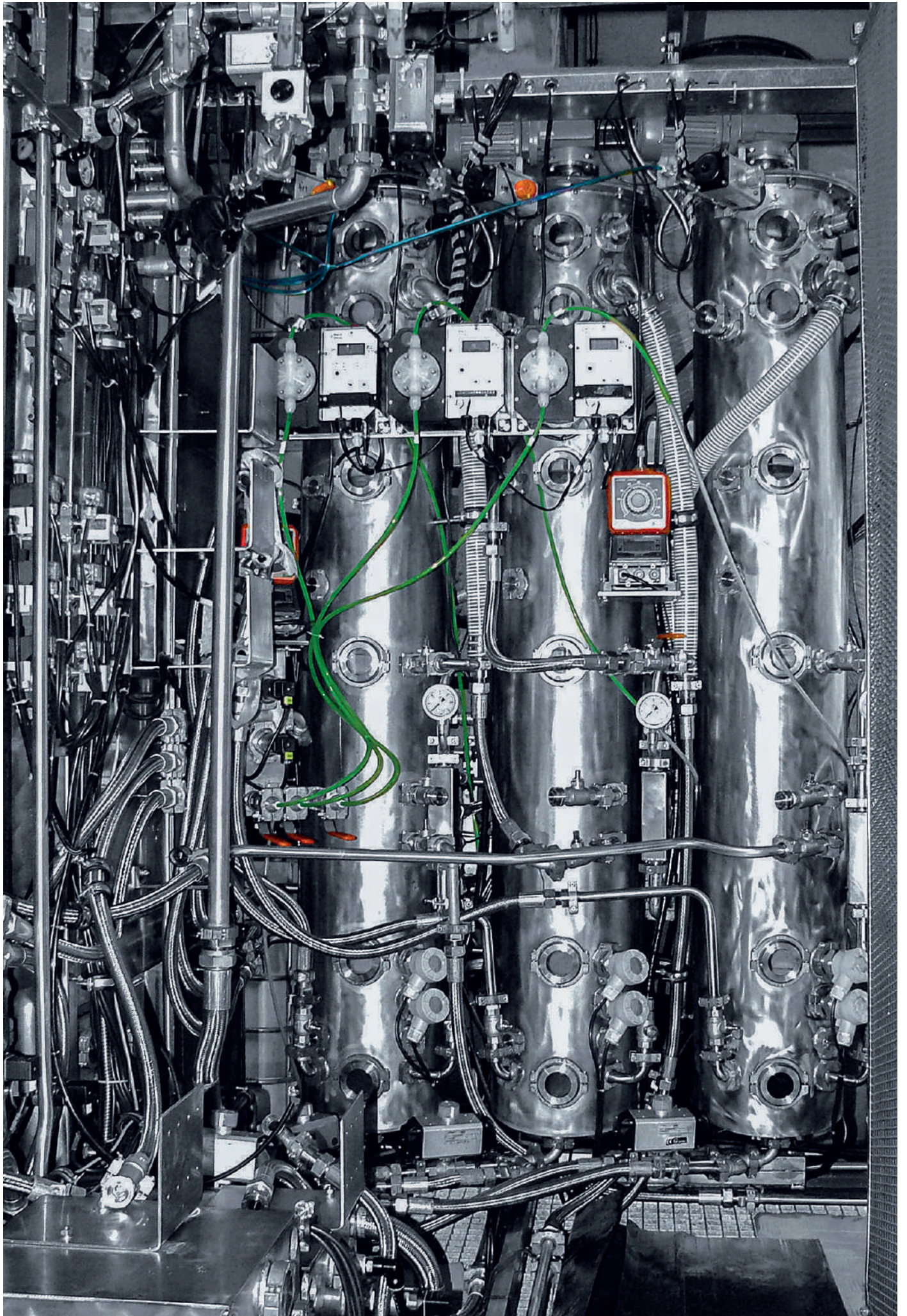

GEWINDEFITTINGS PN16

- » immer maßhaltig
- » ISO 4144
- » 3.1 Zeugnis verfügbar
- » Material V4A | AISI 316
- » Teile sind untereinander tauschbar
- » Produkte sind kurzfristig lieferbar
- » Bestätigung für Trinkwasser

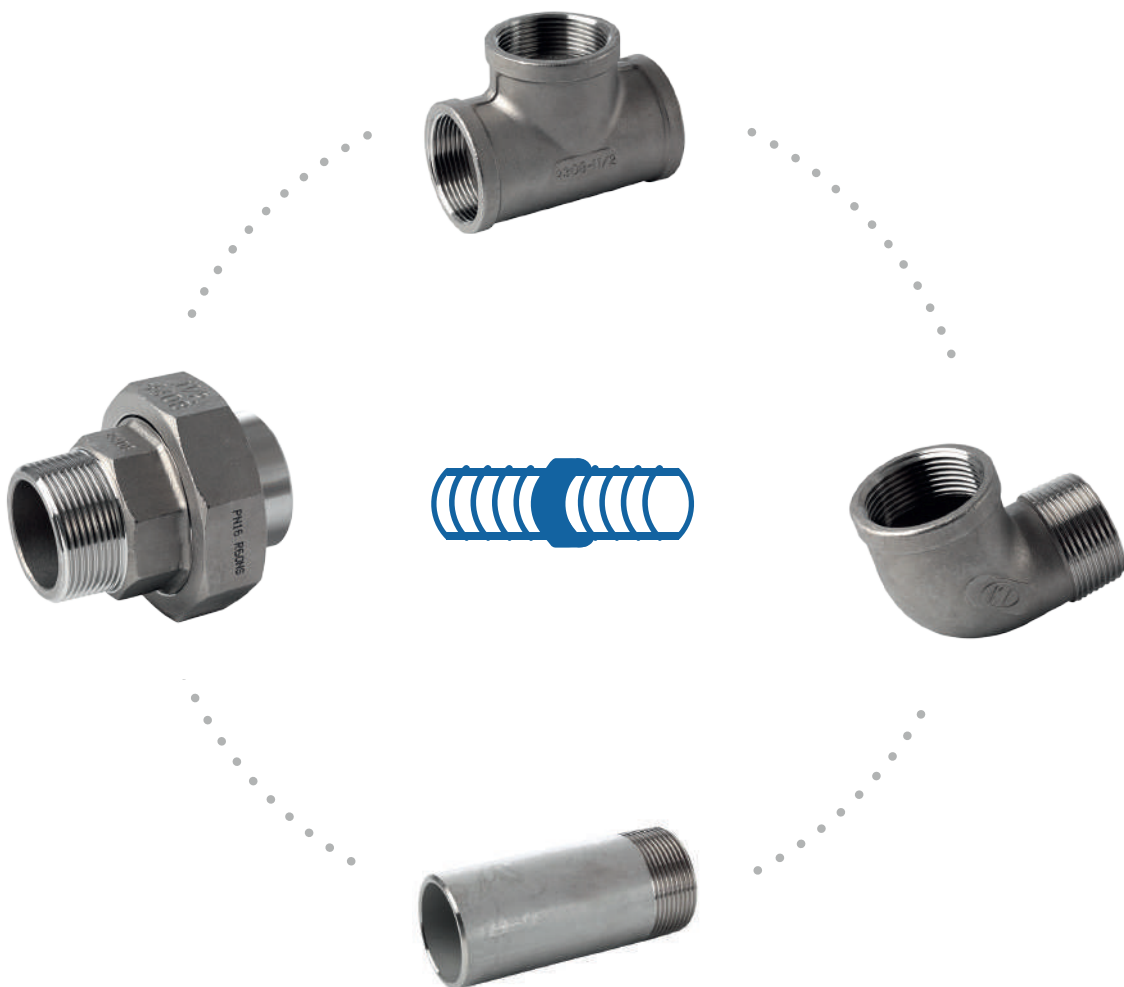



WINKEL 90°, PN16

ISO 228-1G



Bezeichnung	Art.Nr.	ØB	L
1/8"	KI-301-006	15,5 mm	17,5 mm
1/4"	KI-301-008	19,0 mm	19,5 mm
3/8"	KI-301-010	22,5 mm	23,5 mm
1/2"	KI-301-015	27,5 mm	27,5 mm
3/4"	KI-301-020	33,0 mm	32,5 mm
1"	KI-301-025	40,5 mm	38,5 mm
5/4"	KI-301-032	50,0 mm	45,5 mm
3/4"	KI-301-040	56,5 mm	48,5 mm
2"	KI-301-050	70,0 mm	57,5 mm
2 1/2"	KI-301-065	86,5 mm	69,5 mm
3"	KI-301-080	100,0 mm	78,5 mm
4"	KI-301-100	126,0 mm	96,5 mm

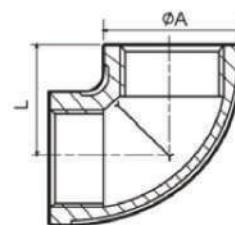

WINKEL IG/IG 90° REDUZIERT, PN16

ISO 228-1G



Bezeichnung	Art.Nr.	ØA	ØC	L1	L2
1/4" - 1/8"	KI-301R-1-008	19,0 mm	15,5 mm	18,5 mm	18,5 mm
3/8" - 1/4"	KI-301R-1-010	25,5 mm	19,0 mm	20,5 mm	22,5 mm
1/2" - 3/8"	KI-301R-1-015	27,5 mm	22,5 mm	26,5 mm	25,5 mm
3/4" - 1/2"	KI-301R-1-020	33,0 mm	27,5 mm	29,5 mm	30,5 mm
1" - 3/4"	KI-301R-1-025	40,5 mm	33,0 mm	34,5 mm	33,5 mm
5/4" - 1"	KI-301R-1-032	50,0 mm	40,5 mm	40,5 mm	42,5 mm
3/4" - 5/4"	KI-301R-1-040	56,5 mm	50,0 mm	45,5 mm	48,5 mm
2" - 5/4"	KI-301R-1-050	70,0 mm	56,5 mm	52,5 mm	55,5 mm
3/8" - 1/8"	KI-301R-2-010	22,5 mm	15,5 mm	19,5 mm	20,5 mm
1/2" - 1/4"	KI-301R-2-015	27,5 mm	19,0 mm	24,5 mm	24,5 mm
3/4" - 3/8"	KI-301R-2-020	33,0 mm	22,5 mm	28,5 mm	28,5 mm
1" - 1/2"	KI-301R-2-025	40,5 mm	27,5 mm	32,5 mm	33,5 mm
5/4" - 3/4"	KI-301R-2-032	50,0 mm	33,0 mm	38,5 mm	40,5 mm
3/4" - 1"	KI-301R-2-040	56,5 mm	40,5 mm	41,5 mm	45,5 mm
2" - 5/4"	KI-301R-2-050	70,0 mm	50,0 mm	48,5 mm	54,5 mm
1/2" - 1/8"	KI-301R-3-015	27,5 mm	15,5 mm	22,5 mm	23,5 mm
3/4" - 1/4"	KI-301R-3-020	33,0 mm	19,0 mm	27,5 mm	26,5 mm
1" - 3/8"	KI-301R-3-025	40,5 mm	22,5 mm	30,5 mm	32,0 mm
5/4" - 1/2"	KI-301R-3-032	50,0 mm	27,5 mm	36,5 mm	38,5 mm
3/4" - 3/4"	KI-301R-3-040	56,5 mm	33,0 mm	38,5 mm	43,5 mm
2" - 1"	KI-301R-3-050	70,0 mm	40,5 mm	46,5 mm	53,5 mm
1" - 1/4"	KI-301R-4-025	40,5 mm	19,0 mm	28,5 mm	30,5 mm
5/4" - 3/8"	KI-301R-4-032	50,0 mm	22,5 mm	34,0 mm	36,5 mm
3/4" - 1/2"	KI-301R-4-040	56,5 mm	27,5 mm	36,0 mm	41,5 mm
2" - 3/4"	KI-301R-4-050	70,0 mm	33,0 mm	44,0 mm	52,5 mm
5/4" - 3/8"	KI-301R-5-040	56,5 mm	22,5 mm	34,0 mm	40,0 mm
2" - 1/2"	KI-301R-5-050	70,0 mm	27,5 mm	42,0 mm	51,5 mm

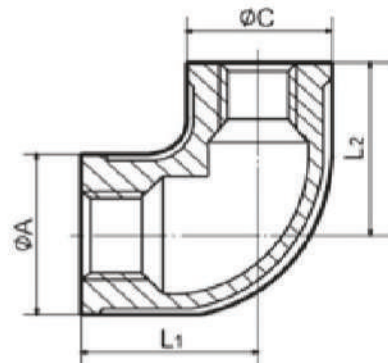

WINKEL 90°, PN16

ISO 228-1G

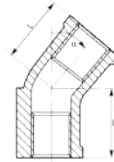

Bezeichnung	Art.Nr.	α	L
1/2"	KI-301W-015-45	45°	22,8 mm
1/2"	KI-301W-015-90	90°	27,7 mm



KREUZSTÜCK, PN16

ISO 228-1G



Bezeichnung	Art.Nr.	L	SW
1/4"	KI-302-006	15,5 mm	17,5 mm
1/4"	KI-302-008	19,0 mm	19,5 mm
3/8"	KI-302-010	22,5 mm	23,5 mm
1/2"	KI-302-015	27,0 mm	27,5 mm
3/4"	KI-302-020	32,5 mm	32,5 mm
1"	KI-302-025	40,0 mm	38,5 mm
5/4"	KI-302-032	50,0 mm	45,5 mm
3/4"	KI-302-040	56,5 mm	48,5 mm
2"	KI-302-050	69,0 mm	57,5 mm
2 1/2"	KI-302-065	86,5 mm	69,5 mm
3"	KI-302-080	100,0 mm	78,5 mm
4"	KI-302-100	126,0 mm	96,5 mm

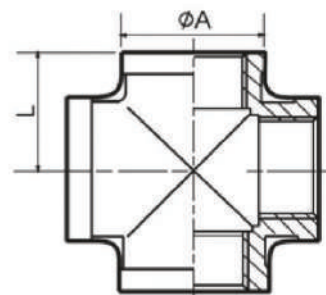

WINKEL 45°, PN16

ISO 228-1G



Bezeichnung	Art.Nr.	ØA	L
1/4"	KI-303-006	15,5 mm	16,5 mm
1/4"	KI-303-008	19,0 mm	17,5 mm
3/8"	KI-303-010	22,5 mm	19,5 mm
1/2"	KI-303-015	27,0 mm	21,5 mm
3/4"	KI-303-020	32,5 mm	25,5 mm
1"	KI-303-025	40,0 mm	29,5 mm
5/4"	KI-303-032	50,0 mm	33,5 mm
3/4"	KI-303-040	56,5 mm	37,5 mm
2"	KI-303-050	69,0 mm	42,5 mm
2 1/2"	KI-303-065	86,5 mm	49,5 mm
3"	KI-303-080	100,0 mm	54,5 mm
4"	KI-303-100	126,0 mm	64,5 mm

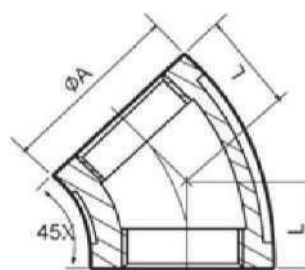

WINKEL IG/AG 45°, PN16

ISO 7-1R / ISO 228-1G



Bezeichnung	Art.Nr.	ØA	L	L1
1/8"	KI-303IA-006	17 mm	16 mm	21 mm
1/4"	KI-303IA-008	21 mm	17 mm	23 mm
3/8"	KI-303IA-010	25 mm	19 mm	27 mm
1/2"	KI-303IA-015	29 mm	21 mm	31 mm
3/4"	KI-303IA-020	35 mm	25 mm	36 mm
1"	KI-303IA-025	43 mm	29 mm	42 mm
1 1/4"	KI-303IA-032	52 mm	34 mm	49 mm
1 1/2"	KI-303IA-040	58 mm	37 mm	51 mm
2"	KI-303IA-050	71 mm	42 mm	59 mm
2 1/2"	KI-303IA-065	88 mm	49 mm	71 mm
3"	KI-303IA-080	101 mm	54 mm	79 mm
4"	KI-303IA-100	129 mm	65 mm	96 mm

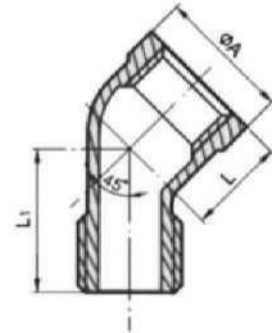

WINKEL IG/AG 90°, PN16

ISO 7-1R / ISO 228-1G



Bezeichnung	Art.Nr.	ØB	L	SW
1/8"	KI-304-006	15,5 mm	26,5 mm	17,5 mm
1/4"	KI-304-008	19,0 mm	27,5 mm	19,5 mm
3/8"	KI-304-010	22,5 mm	29,5 mm	23,5 mm
1/2"	KI-304-015	27,0 mm	35,5 mm	27,5 mm
3/4"	KI-304-020	32,5 mm	40,5 mm	32,5 mm
1"	KI-304-025	40,0 mm	46,5 mm	38,5 mm
1 1/4"	KI-304-032	50,0 mm	54,5 mm	45,5 mm
1 1/2"	KI-304-040	56,5 mm	57,5 mm	48,5 mm
2"	KI-304-050	69,0 mm	70,5 mm	57,5 mm
2 1/2"	KI-304-065	86,5 mm	83,5 mm	69,5 mm
3"	KI-304-080	100,0 mm	94,5 mm	78,5 mm
4"	KI-304-100	126,0 mm	115,5 mm	97,5 mm

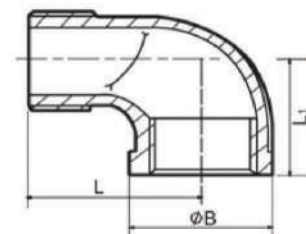



BOGEN 90° OHNE MUFFE

ISO 7-1R



Bezeichnung	Art.Nr.	L	ØA
1/6"	KI-305-006	50 mm	10,2 mm
1/4"	KI-305-008	60 mm	13,5 mm
3/8"	KI-305-010	80 mm	18,2 mm
1/2"	KI-305-015	80 mm	21,3 mm
3/4"	KI-305-020	100 mm	26,9 mm
1"	KI-305-025	120 mm	33,8 mm
5/4"	KI-305-032	140 mm	42,4 mm
3/4"	KI-305-040	160 mm	48,3 mm
2"	KI-305-050	190 mm	60,3 mm

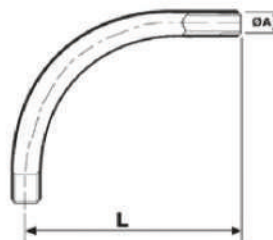

Y-STÜCK IG/IG/IG, PN16

ISO 228-1G



Bezeichnung	Art.Nr.	ØA	L	L1
1/6"	KI-306-006	17 mm	10 mm	17 mm
1/4"	KI-306-008	21 mm	13 mm	19 mm
3/8"	KI-306-010	25 mm	14 mm	23 mm
1/2"	KI-306-015	29 mm	18 mm	27 mm
3/4"	KI-306-020	35 mm	20 mm	32 mm
1"	KI-306-025	43 mm	23 mm	38 mm
5/4"	KI-306-032	52 mm	28 mm	46 mm
3/4"	KI-306-040	58 mm	30 mm	48 mm
2"	KI-306-050	71 mm	34 mm	57 mm



T-STÜCK, PN16

ISO 228-1G



Bezeichnung	Art.Nr.	ØA	L
1/6"	KI-307-006	15,5 mm	17,5 mm
1/4"	KI-307-008	19,0 mm	19,5 mm
3/8"	KI-307-010	22,5 mm	23,5 mm
1/2"	KI-307-015	27,5 mm	27,5 mm
3/4"	KI-307-020	33,0 mm	32,5 mm
1"	KI-307-025	40,5 mm	38,5 mm
5/4"	KI-307-032	50,0 mm	45,5 mm
3/4"	KI-307-040	56,5 mm	48,5 mm
2"	KI-307-050	70,0 mm	57,5 mm
2 1/2"	KI-307-065	86,5 mm	69,5 mm
3"	KI-307-080	100,0 mm	78,5 mm
4"	KI-307-100	126,0 mm	96,5 mm

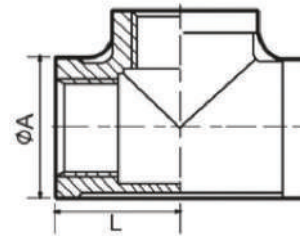

T-STÜCK „REDUZIERT“ , PN16

ISO 228-1G



Bezeichnung	Art.Nr.	ØA	ØC	L1	L2
1/4" - 1/6" - 1/4"	KI-307R-1-008	15,5 mm	19,0 mm	18,5 mm	18,5 mm
3/8" - 1/4" - 3/8"	KI-307R-1-010	19,0 mm	22,5 mm	20,5 mm	22,5 mm
1/2" - 3/8" - 1/2"	KI-307R-1-015	22,5 mm	27,5 mm	26,5 mm	25,5 mm
3/4" - 1/2" - 3/4"	KI-307R-1-020	27,5 mm	33,0 mm	29,5 mm	30,5 mm
1" - 3/4" - 1"	KI-307R-1-025	33,0 mm	40,5 mm	34,5 mm	35,5 mm
5/4" - 1" - 5/4"	KI-307R-1-032	40,5 mm	50,0 mm	40,5 mm	42,5 mm
3/4" - 3/4" - 3/4"	KI-307R-1-040	50,0 mm	56,5 mm	45,5 mm	48,5 mm
2" - 3/4" - 2"	KI-307R-1-050	56,5 mm	70,0 mm	52,5 mm	55,5 mm
3/8" - 1/6" - 3/8"	KI-307R-2-010	15,5 mm	22,5 mm	19,5 mm	20,5 mm
1/2" - 1/4" - 1/2"	KI-307R-2-015	19,0 mm	27,5 mm	24,5 mm	24,5 mm
3/4" - 3/8" - 3/4"	KI-307R-2-020	22,5 mm	33,0 mm	28,5 mm	28,5 mm
1" - 1/2" - 1"	KI-307R-2-025	27,5 mm	40,5 mm	32,5 mm	33,5 mm
5/4" - 3/4" - 5/4"	KI-307R-2-032	33,0 mm	50,0 mm	38,5 mm	40,5 mm
3/4" - 1" - 3/4"	KI-307R-2-040	40,5 mm	56,5 mm	41,5 mm	45,5 mm
2" - 5/4" - 2"	KI-307R-2-050	50,0 mm	70,0 mm	48,5 mm	54,5 mm
1/2" - 1/6" - 1/2"	KI-307R-3-015	15,5 mm	27,5 mm	23,5 mm	23,5 mm
3/4" - 1/4" - 3/4"	KI-307R-3-020	19,0 mm	33,0 mm	26,5 mm	27,5 mm
1" - 3/8" - 1"	KI-307R-3-025	22,5 mm	40,5 mm	30,5 mm	32,0 mm
5/4" - 1/2" - 5/4"	KI-307R-3-032	27,5 mm	50,0 mm	36,0 mm	38,5 mm
3/4" - 3/4" - 3/4"	KI-307R-3-040	33,0 mm	56,5 mm	38,5 mm	43,5 mm
2" - 1" - 2"	KI-307R-3-050	40,0 mm	69,0 mm	44,5 mm	51,5 mm
1" - 1/4" - 1"	KI-307R-4-025	19,0 mm	40,5 mm	27,5 mm	30,5 mm
5/4" - 3/8" - 5/4"	KI-307R-4-032	22,5 mm	50,0 mm	34,0 mm	36,5 mm
3/4" - 1/2" - 3/4"	KI-307R-4-040	27,5 mm	56,5 mm	36,0 mm	41,5 mm
2" - 3/4" - 2"	KI-307R-4-050	33,0 mm	69,0 mm	41,5 mm	49,5 mm
5/4" - 3/8" - 5/4"	KI-307R-5-040	22,5 mm	56,5 mm	34,0 mm	40,0 mm
2" - 1/2" - 2"	KI-307R-5-050	27,5 mm	69,0 mm	39,0 mm	47,5 mm

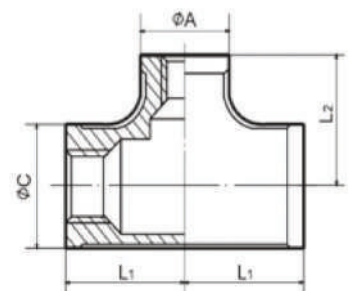



ANSCHWEISSNIPPEL SONDERLÄNGEN

ISO 7-1R



Bezeichnung (ØA)	Art.Nr.	L
1/2"	KI-308SL0030-015-1/2	30 mm
1/4"	KI-308SL0040-008-1/4	40 mm
3/8"	KI-308SL0040-010-3/8	40 mm
1/2"	KI-308SL0040-015-1/2	40 mm
3/8"	KI-308SL0050-010-3/8	50 mm
1/2"	KI-308SL0050-015-1/2	50 mm
3/4"	KI-308SL0050-020-3/4	50 mm
1"	KI-308SL0050-025-1	50 mm
1/2"	KI-308SL0060-015-1/2	60 mm
1"	KI-308SL0060-025-1	60 mm
5/8"	KI-308SL0060-032-5/4	60 mm
5/8"	KI-308SL0070-032-5/4	70 mm
1/2"	KI-308SL0080-015-1/2	80 mm
3/4"	KI-308SL0080-020-3/4	80 mm
5/8"	KI-308SL0080-040-6/4	80 mm
2"	KI-308SL0080-050-2	80 mm
1/4"	KI-308SL0100-008-1/4	100 mm
3/8"	KI-308SL0100-010-3/8	100 mm
1/2"	KI-308SL0100-015-1/2	100 mm
3/4"	KI-308SL0100-020-3/4	100 mm
1"	KI-308SL0100-025-1	100 mm
5/4"	KI-308SL0100-032-5/4	100 mm
5/4"	KI-308SL0100-040-6/4	100 mm
2"	KI-308SL0100-050-2	100 mm
1/2"	KI-308SL0110-015-1/2	110 mm
1"	KI-308SL0120-025-1	120 mm
5/4"	KI-308SL0120-032-5/4	120 mm
1"	KI-308SL0140-025-1	140 mm
1/4"	KI-308SL0150-008-1/4	150 mm
3/8"	KI-308SL0150-010-3/8	150 mm
1/2"	KI-308SL0150-015-1/2	150 mm
3/4"	KI-308SL0150-020-3/4	150 mm
1"	KI-308SL0150-025-1	150 mm
5/4"	KI-308SL0150-032-5/4	150 mm
5/4"	KI-308SL0150-040-6/4	150 mm
2"	KI-308SL0150-050-2	150 mm
1"	KI-308SL0160-025-1	160 mm
1"	KI-308SL0170-025-1	170 mm
5/4"	KI-308SL0180-040-6/4	180 mm
2"	KI-308SL0180-050-2	180 mm
1/4"	KI-308SL0200-008-1/4	200 mm
1/2"	KI-308SL0200-015-1/2	200 mm
3/4"	KI-308SL0200-020-3/4	200 mm
1"	KI-308SL0200-025-1	200 mm
5/4"	KI-308SL0200-032-5/4	200 mm
5/4"	KI-308SL0200-040-6/4	200 mm
2"	KI-308SL0200-050-2	200 mm

Bezeichnung (ØA)	Art.Nr.	L
1/4"	KI-308SL0300-008-1/4	300 mm
1/2"	KI-308SL0300-015-1/2	300 mm
3/4"	KI-308SL0300-020-3/4	300 mm
1"	KI-308SL0300-025-1	300 mm
5/4"	KI-308SL0300-032-5/4	300 mm
5/4"	KI-308SL0300-040-6/4	300 mm
2"	KI-308SL0300-050-2	300 mm

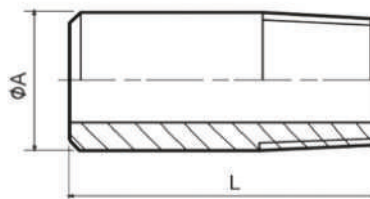

ANSCHWEISSNIPPEL

ISO 7-1R



Bezeichnung (ØA)	Art.Nr.	Länge
1/8"	KI-308-006	30 mm
1/4"	KI-308-008	30 mm
3/8"	KI-308-010	30 mm
1/2"	KI-308-015	35 mm
3/4"	KI-308-020	40 mm
1"	KI-308-025	40 mm
5/4"	KI-308-032	50 mm
5/4"	KI-308-040	50 mm
2"	KI-308-050	50 mm
2 1/2"	KI-308-065	60 mm
3"	KI-308-080	70 mm
4"	KI-308-100	80 mm

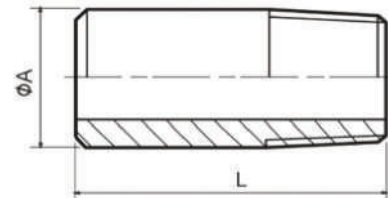

ROHRNIPPEL

AG, ISO 228



Bezeichnung	Art.Nr.	L
1/8"	KI-309-006	16,0 mm
1/4"	KI-309-008	18,0 mm
3/8"	KI-309-010	25,0 mm
1/2"	KI-309-015	25,3 mm
3/4"	KI-309-020	30,0 mm
1"	KI-309-025	35,0 mm
5/4"	KI-309-032	38,0 mm
5/4"	KI-309-040	38,0 mm
2"	KI-309-050	45,0 mm

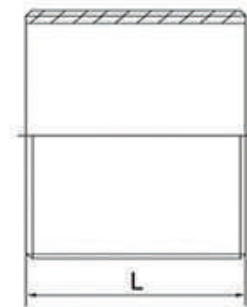



ROHRDOPPELNIPPEL SONDERLÄNGEN

ISO 7-1R

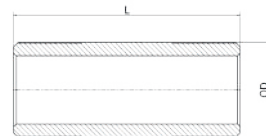

Bezeichnung	Art.Nr.	L	OD
1/2"	KI-310SL0030-015-1/2	30 mm	21,0 mm
1/8"	KI-310SL0040-006-1/8	40 mm	10,0 mm
1/4"	KI-310SL0040-008-1/4	40 mm	13,5 mm
1/2"	KI-310SL0040-015-1/2	40 mm	21,0 mm
3/4"	KI-310SL0040-020-3/4	40 mm	27,0 mm
1"	KI-310SL0040-025-1	40 mm	33,5 mm
1/4"	KI-310SL0050-008-1/4	50 mm	13,5 mm
1/2"	KI-310SL0050-015-1/2	50 mm	21,0 mm
3/4"	KI-310SL0050-020-3/4	50 mm	27,0 mm
1"	KI-310SL0050-025-1	50 mm	33,5 mm
5/4"	KI-310SL0050-032-5/4	50 mm	42,0 mm
5/4"	KI-310SL0050-040-6/4	50 mm	48,0 mm
1/4"	KI-310SL0060-008-1/4	60 mm	13,5 mm
3/4"	KI-310SL0060-010-3/8	60 mm	17,0 mm
5/4"	KI-310SL0060-032-5/4	60 mm	42,0 mm
2"	KI-310SL0060-050-2	60 mm	60,5 mm
1/2"	KI-310SL0070-015-1/2	70 mm	21,0 mm
3/4"	KI-310SL0070-020-3/4	70 mm	27,0 mm
3/4"	KI-310SL0080-010-3/8	80 mm	17,0 mm
1/2"	KI-310SL0080-015-1/2	80 mm	21,0 mm
3/4"	KI-310SL0080-020-3/4	80 mm	27,0 mm
1"	KI-310SL0080-025-1	80 mm	33,5 mm
2"	KI-310SL0080-050-2	80 mm	60,5 mm
1/2"	KI-310SL0090-015-1/2	90 mm	21,0 mm
1/4"	KI-310SL0100-008-1/4	100 mm	13,5 mm
3/4"	KI-310SL0100-010-3/8	100 mm	17,0 mm
1/2"	KI-310SL0100-015-1/2	100 mm	21,0 mm
3/4"	KI-310SL0100-020-3/4	100 mm	27,0 mm
1"	KI-310SL0100-025-1	100 mm	33,5 mm
5/4"	KI-310SL0100-032-5/4	100 mm	42,0 mm
5/4"	KI-310SL0100-040-6/4	100 mm	48,0 mm
1/2"	KI-310SL0110-015-1/2	110 mm	21,0 mm
1/2"	KI-310SL0120-015-1/2	120 mm	21,0 mm
3/4"	KI-310SL0120-020-3/4	120 mm	27,0 mm
1"	KI-310SL0120-025-1	120 mm	33,5 mm
2"	KI-310SL0120-050-2	120 mm	60,5 mm
1/2"	KI-310SL0130-015-1/2	130 mm	21,0 mm
1/4"	KI-310SL0150-008-1/4	150 mm	13,5 mm
3/4"	KI-310SL0150-010-3/8	150 mm	17,0 mm
1/2"	KI-310SL0150-015-1/2	150 mm	21,0 mm
3/4"	KI-310SL0150-020-3/4	150 mm	27,0 mm
1"	KI-310SL0150-025-1	150 mm	33,5 mm
5/4"	KI-310SL0150-032-5/4	150 mm	42,0 mm
5/4"	KI-310SL0150-040-6/4	150 mm	48,0 mm
2"	KI-310SL0150-050-2	150 mm	60,5 mm
1/2"	KI-310SL0160-015-1/2	160 mm	21,0 mm
1/2"	KI-310SL0180-015-1/2	180 mm	21,0 mm

Bezeichnung	Art.Nr.	L	OD
3/4"	KI-310SL0180-020-3/4	180 mm	27,0 mm
1/4"	KI-310SL0200-008-1/4	200 mm	13,5 mm
3/4"	KI-310SL0200-010-3/8	200 mm	17,0 mm
1/2"	KI-310SL0200-015-1/2	200 mm	21,0 mm
3/4"	KI-310SL0200-020-3/4	200 mm	27,0 mm
1"	KI-310SL0200-025-1	200 mm	33,5 mm
5/4"	KI-310SL0200-032-5/4	200 mm	42,0 mm
5/4"	KI-310SL0200-040-6/4	200 mm	48,0 mm
2"	KI-310SL0200-050-2	200 mm	60,5 mm
1/4"	KI-310SL0250-008-1/4	250 mm	13,5 mm
1/2"	KI-310SL0250-015-1/2	250 mm	21,0 mm
3/4"	KI-310SL0250-020-3/4	250 mm	27,0 mm
1"	KI-310SL0250-025-1	250 mm	33,5 mm
5/4"	KI-310SL0250-032-5/4	250 mm	42,0 mm
5/4"	KI-310SL0250-040-6/4	250 mm	48,0 mm
2"	KI-310SL0250-050-2	250 mm	60,5 mm
1/4"	KI-310SL0300-008-1/4	300 mm	13,5 mm
3/4"	KI-310SL0300-010-3/8	300 mm	17,0 mm
1/2"	KI-310SL0300-015-1/2	300 mm	21,0 mm
3/4"	KI-310SL0300-020-3/4	300 mm	27,0 mm
1"	KI-310SL0300-025-1	300 mm	33,5 mm
5/4"	KI-310SL0300-032-5/4	300 mm	42,0 mm
5/4"	KI-310SL0300-040-6/4	300 mm	48,0 mm
2"	KI-310SL0300-050-2	300 mm	60,5 mm

GEWINDESCHNEIDEN

Im 24h Stunden-Service

Anschweiß- und Rohrdoppelnippel.

Wir schneiden für Sie Gewindenippel in Ihrer Wunschlänge bis 6 Meter Rohrlänge, Durchmesser 1/2" – 3" möglich in V2A oder V4A.

ROHRDOPPELNIPPEL

AG, ISO 7-1R



Bezeichnung	Art.Nr.	L	OD
1/4"	KI-310-008	30 mm	13,5 mm
3/8"	KI-310-010	40 mm	17,0 mm
1/2"	KI-310-015	60 mm	21,0 mm
3/4"	KI-310-020	60 mm	27,0 mm
1"	KI-310-025	60 mm	33,5 mm
5/4"	KI-310-032	80 mm	42,0 mm
5/4"	KI-310-040	80 mm	48,0 mm
2"	KI-310-050	100 mm	60,5 mm
2 1/2"	KI-310-065	100 mm	76,5 mm
3"	KI-310-080	120 mm	89,0 mm
4"	KI-310-100	120 mm	114,0 mm

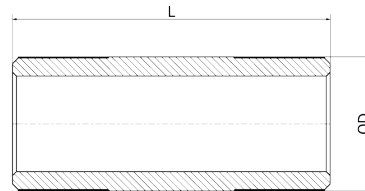

VERSCHRAUBUNG IG/IG FLACH DICHT., PN16

ISO 228-1G



Bezeichnung	Art.Nr.	L	SW
1/8"	KI-311-006	30,5 mm	24 mm
1/4"	KI-311-008	34,0 mm	30 mm
3/8"	KI-311-010	37,0 mm	35 mm
1/2"	KI-311-015	40,5 mm	41 mm
3/4"	KI-311-020	43,0 mm	48 mm
1"	KI-311-025	50,5 mm	54 mm
5/4"	KI-311-032	54,5 mm	65 mm
5/4"	KI-311-040	58,5 mm	72 mm
2"	KI-311-050	65,5 mm	88 mm
2 1/2"	KI-311-065	76,0 mm	109 mm
3"	KI-311-080	84,0 mm	122 mm
4"	KI-311-100	110,0 mm	150 mm

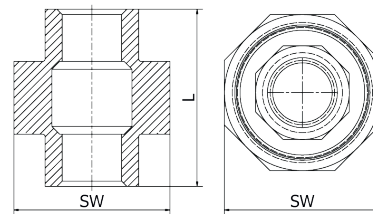



VERSCHRAUBUNG AG/AG FLACH DICHT., PN16

ISO 7-1R



Bezeichnung	Art.Nr.	L	SW
1/4"	KI-311AGA-006	52,0 mm	25 mm
1/4"	KI-311AGA-008	61,0 mm	30 mm
3/8"	KI-311AGA-010	62,5 mm	35 mm
1/2"	KI-311AGA-015	73,0 mm	42 mm
3/4"	KI-311AGA-020	82,0 mm	47 mm
1"	KI-311AGA-025	90,0 mm	53 mm
3/4"	KI-311AGA-032	104,0 mm	71 mm
3/4"	KI-311AGA-040	109,6 mm	78 mm
2"	KI-311AGA-050	118,0 mm	92 mm
2 1/2"	KI-311AGA-065	145,0 mm	112 mm
3"	KI-311AGA-080	164,0 mm	126 mm
4"	KI-311AGA-100	205,0 mm	157 mm

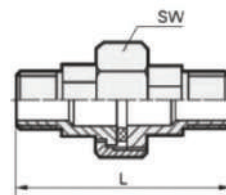

WINKELVERSCHR. IG/IG FLACH DICHT., PN16

ISO 228-1G



Bezeichnung	Art.Nr.	L1	L2	SW
1/4"	KI-311W-008	46,2 mm	21 mm	30 mm
3/8"	KI-311W-010	49,0 mm	25 mm	35 mm
1/2"	KI-311W-015	56,0 mm	28 mm	42 mm
3/4"	KI-311W-020	62,7 mm	33 mm	47 mm
1"	KI-311W-025	68,0 mm	38 mm	53 mm
3/4"	KI-311W-032	79,5 mm	45 mm	71 mm
3/4"	KI-311W-040	88,0 mm	50 mm	78 mm
2"	KI-311W-050	93,8 mm	58 mm	92 mm

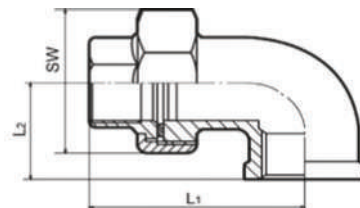

WINKELVERSCHR. IG/AG FLACH DICHT., PN16

ISO 228-1G/ISO 7-1R



Bezeichnung	Art.Nr.	L1	L2	SW
1/4"	KI-311WIA-008	58,6 mm	21 mm	30 mm
3/8"	KI-311WIA-010	61,0 mm	25 mm	35 mm
1/2"	KI-311WIA-015	71,0 mm	28 mm	42 mm
3/4"	KI-311WIA-020	78,7 mm	33 mm	47 mm
1"	KI-311WIA-025	88,4 mm	38 mm	53 mm
3/4"	KI-311WIA-032	102,9 mm	45 mm	71 mm
3/4"	KI-311WIA-040	110,3 mm	50 mm	78 mm
2"	KI-311WIA-050	119,4 mm	58 mm	92 mm

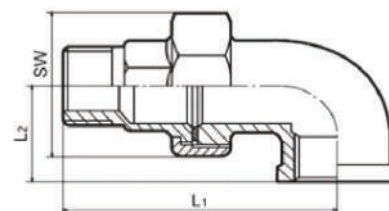



VERSCHRAUBUNG IG/IG KON. DICT., PN16

ISO 228-1G



Bezeichnung	Art.Nr.	L	SW
1/8"	KI-312-006	30,5 mm	24 mm
1/4"	KI-312-008	34,0 mm	30 mm
3/8"	KI-312-010	37,0 mm	35 mm
1/2"	KI-312-015	40,5 mm	41 mm
3/4"	KI-312-020	43,0 mm	48 mm
1"	KI-312-025	50,5 mm	54 mm
5/8"	KI-312-032	54,5 mm	65 mm
3/4"	KI-312-040	58,5 mm	72 mm
2"	KI-312-050	65,5 mm	88 mm
2 1/2"	KI-312-065	76,0 mm	109 mm
3"	KI-312-080	84,0 mm	122 mm
4"	KI-312-100	111,0 mm	150 mm

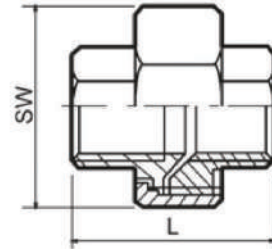

VERSCHRAUBUNG AG/AG KON. DICT., PN16

ISO 7-1R



Bezeichnung	Art.Nr.	L	SW
1/8"	KI-312AGA-006	52,0 mm	25 mm
1/4"	KI-312AGA-008	61,0 mm	30 mm
3/8"	KI-312AGA-010	62,5 mm	35 mm
1/2"	KI-312AGA-015	73,0 mm	42 mm
3/4"	KI-312AGA-020	82,0 mm	47 mm
1"	KI-312AGA-025	90,0 mm	53 mm
5/8"	KI-312AGA-032	104,0 mm	71 mm
3/4"	KI-312AGA-040	109,6 mm	78 mm
2"	KI-312AGA-050	118,0 mm	92 mm
2 1/2"	KI-312AGA-065	145,0 mm	112 mm
3"	KI-312AGA-080	164,0 mm	126 mm
4"	KI-312AGA-100	205,0 mm	157 mm

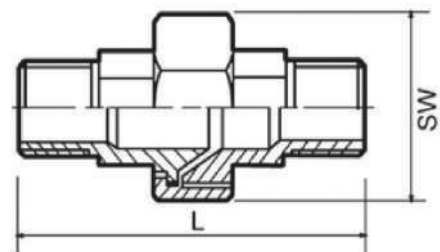



WINKELVERSCHR. IG/IG KON. DICT., PN16

ISO 228-1G



Bezeichnung	Art.Nr.	L1	L2	SW
1/4"	KI-312W-008	46,2 mm	21 mm	30 mm
3/8"	KI-312W-010	49,0 mm	25 mm	35 mm
1/2"	KI-312W-015	56,0 mm	28 mm	42 mm
3/4"	KI-312W-020	62,7 mm	33 mm	47 mm
1"	KI-312W-025	68,0 mm	38 mm	53 mm
5/8"	KI-312W-032	79,5 mm	45 mm	71 mm
3/4"	KI-312W-040	88,0 mm	50 mm	78 mm
2"	KI-312W-050	93,8 mm	58 mm	92 mm

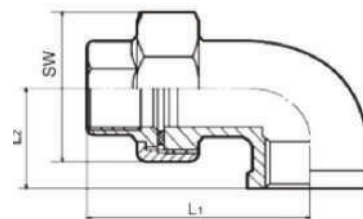

WINKELVERSCHR. IG/AG KON. DICT., PN16

ISO 228-1G/ISO 7-1R



Bezeichnung	Art.Nr.	L1	L2	SW
1/4"	KI-312WIA-008	58,6 mm	21 mm	30 mm
3/8"	KI-312WIA-010	61,0 mm	25 mm	35 mm
1/2"	KI-312WIA-015	71,0 mm	28 mm	42 mm
3/4"	KI-312WIA-020	78,7 mm	33 mm	47 mm
1"	KI-312WIA-025	88,4 mm	38 mm	53 mm
5/8"	KI-312WIA-032	102,9 mm	45 mm	71 mm
3/4"	KI-312WIA-040	110,3 mm	50 mm	78 mm
2"	KI-312WIA-050	119,4 mm	58 mm	92 mm

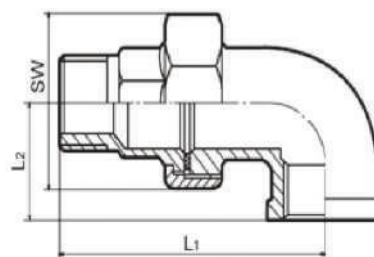

VERSCHRAUBUNG AE/AE KON. DICHT., PN16

ANSI B16.25



Bezeichnung	Art.Nr.	L	SW	D	d
1/8"	KI-313-006	29,0 mm	25 mm	10,2 mm	8,1 mm
1/4"	KI-313-008	35,5 mm	30 mm	13,5 mm	10,0 mm
3/8"	KI-313-010	38,5 mm	35 mm	17,2 mm	12,7 mm
1/2"	KI-313-015	42,0 mm	42 mm	21,3 mm	16,7 mm
3/4"	KI-313-020	50,4 mm	47 mm	26,9 mm	21,5 mm
1"	KI-313-025	48,0 mm	53 mm	33,7 mm	26,5 mm
5/4"	KI-313-032	59,0 mm	71 mm	42,4 mm	35,8 mm
3/4"	KI-313-040	64,0 mm	78 mm	48,3 mm	42,0 mm
2"	KI-313-050	69,0 mm	92 mm	60,3 mm	53,3 mm
2 1/2"	KI-313-065	80,0 mm	112 mm	76,1 mm	66,5 mm
3"	KI-313-080	88,0 mm	126 mm	88,9 mm	78,5 mm
4"	KI-313-100	108,0 mm	157 mm	114,3 mm	104,0 mm

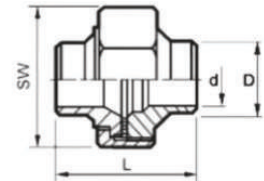

VERSCHRAUBUNG AE/AE FLACH DICHT., PN16

ANSI B16.25



Bezeichnung	Art.Nr.	L	SW	D	d
1/8"	KI-314-006	29,0 mm	25 mm	10,2 mm	8,1 mm
1/4"	KI-314-008	35,5 mm	30 mm	13,5 mm	10,0 mm
3/8"	KI-314-010	38,0 mm	35 mm	17,2 mm	12,7 mm
1/2"	KI-314-015	42,0 mm	42 mm	21,3 mm	16,7 mm
3/4"	KI-314-020	50,4 mm	47 mm	26,9 mm	21,5 mm
1"	KI-314-025	48,0 mm	53 mm	33,7 mm	26,5 mm
5/4"	KI-314-032	59,0 mm	71 mm	42,4 mm	35,8 mm
3/4"	KI-314-040	64,0 mm	78 mm	48,3 mm	42,0 mm
2"	KI-314-050	69,0 mm	92 mm	60,3 mm	53,3 mm
2 1/2"	KI-314-065	80,0 mm	112 mm	76,1 mm	66,5 mm
3"	KI-314-080	88,0 mm	126 mm	88,9 mm	78,5 mm
4"	KI-314-100	108,0 mm	157 mm	114,3 mm	104,0 mm

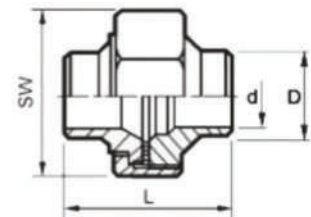



VERSCHRAUBUNG IG/AG KON. DICT., PN16

ISO 228-1G/ISO 7-1R



Bezeichnung	Art.Nr.	L	SW
1/8"	KI-315-006	39,0 mm	24 mm
1/4"	KI-315-008	45,0 mm	30 mm
3/8"	KI-315-010	48,5 mm	35 mm
1/2"	KI-315-015	55,5 mm	41 mm
3/4"	KI-315-020	59,0 mm	48 mm
1"	KI-315-025	69,0 mm	54 mm
5/4"	KI-315-032	75,5 mm	65 mm
3/4"	KI-315-040	79,5 mm	72 mm
2"	KI-315-050	91,0 mm	88 mm
2 1/2"	KI-315-065	103,5 mm	109 mm
3"	KI-315-080	114,5 mm	122 mm
4"	KI-315-100	147,5 mm	150 mm

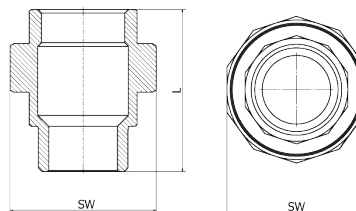

VERSCHRAUBUNG IG/AG FLACH DICT., PN16

ISO 228-1G/ISO 7-1R



Bezeichnung	Art.Nr.	L	SW
1/8"	KI-316-006	39,0 mm	24 mm
1/4"	KI-316-008	45,0 mm	30 mm
3/8"	KI-316-010	48,5 mm	35 mm
1/2"	KI-316-015	55,5 mm	41 mm
3/4"	KI-316-020	59,0 mm	48 mm
1"	KI-316-025	69,0 mm	54 mm
5/4"	KI-316-032	75,5 mm	65 mm
3/4"	KI-316-040	79,5 mm	72 mm
2"	KI-316-050	91,0 mm	88 mm
2 1/2"	KI-316-065	103,5 mm	109 mm
3"	KI-316-080	114,5 mm	122 mm
4"	KI-316-100	147,5 mm	150 mm

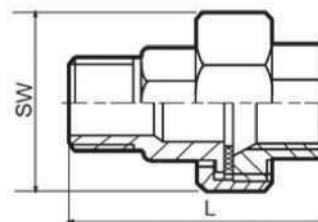

VERSCHRAUBUNG AE/AG KON. DICHT., PN16

ANSI B16.25



Bezeichnung	Art.Nr.	L	SW	D	d
1/4"	KI-318-008	50,0 mm	30 mm	13,5 mm	10,0 mm
3/8"	KI-318-010	50,0 mm	35 mm	17,2 mm	12,7 mm
1/2"	KI-318-015	58,4 mm	42 mm	21,3 mm	16,7 mm
3/4"	KI-318-020	66,0 mm	47 mm	26,9 mm	21,5 mm
1"	KI-318-025	64,4 mm	53 mm	33,7 mm	26,5 mm
5/4"	KI-318-032	83,0 mm	71 mm	42,4 mm	35,8 mm
3/4"	KI-318-040	86,3 mm	78 mm	48,3 mm	42,0 mm
2"	KI-318-050	94,0 mm	92 mm	60,3 mm	53,3 mm

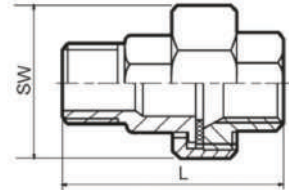

VERSCHRAUBUNG AE/IG KON. DICHT., PN16

ANSI B16.25



Bezeichnung	Art.Nr.	L	SW	D	d
1/4"	KI-319-008	35,5 mm	30 mm	13,5 mm	10,0 mm
3/8"	KI-319-010	38,0 mm	35 mm	17,2 mm	12,7 mm
1/2"	KI-319-015	42,0 mm	42 mm	21,3 mm	16,7 mm
3/4"	KI-319-020	50,4 mm	47 mm	26,9 mm	21,5 mm
1"	KI-319-025	48,0 mm	53 mm	33,7 mm	26,5 mm
5/4"	KI-319-032	59,0 mm	71 mm	42,4 mm	35,8 mm
3/4"	KI-319-040	64,0 mm	78 mm	48,3 mm	42,0 mm
2"	KI-319-050	69,0 mm	92 mm	60,3 mm	53,3 mm

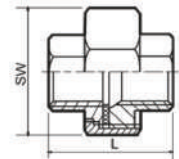



6-KT. RED.- STÜCK PN16

ISO 228-1G



Bezeichnung	Art.Nr.	L	SW
AG 1/4" - IG 1/4"	KI-325-1-008-1/4	15,2 mm	16 mm
AG 3/8" - IG 1/4"	KI-325-1-010-3/8	16,5 mm	18 mm
AG 1/2" - IG 3/8"	KI-325-1-015-1/2	21,0 mm	26 mm
AG 3/4" - IG 1/2"	KI-325-1-020-3/4	24,0 mm	30 mm
AG 1" - IG 3/4"	KI-325-1-025-1	27,0 mm	35 mm
AG 5/4" - IG 1"	KI-325-1-032-5/4	30,0 mm	45 mm
AG 5/4" - IG 5/4"	KI-325-1-040-6/4	29,5 mm	50 mm
AG 2" - IG 5/4"	KI-325-1-050-2	34,0 mm	65 mm
AG 2 1/2" - IG 2"	KI-325-1-065-21/2	36,0 mm	80 mm
AG 3" - IG 2 1/2"	KI-325-1-080-3	40,0 mm	95 mm
AG 4" - IG 3"	KI-325-1-100-4	46,0 mm	120 mm
AG 3/8" - IG 1/8"	KI-325-2-010-3/8	16,5 mm	18 mm
AG 1/2" - IG 1/4"	KI-325-2-015-1/2	21,0 mm	26 mm
AG 3/4" - IG 3/8"	KI-325-2-020-3/4	24,0 mm	30 mm
AG 1" - IG 1/2"	KI-325-2-025-1	27,0 mm	35 mm
AG 5/4" - IG 3/4"	KI-325-2-032-5/4	30,0 mm	45 mm
AG 5/4" - IG 1"	KI-325-2-040-6/4	29,5 mm	50 mm
AG 2" - IG 5/4"	KI-325-2-050-2	34,0 mm	65 mm
AG 2 1/2" - IG 5/4"	KI-325-2-065-21/2	36,0 mm	80 mm
AG 3" - IG 2"	KI-325-2-080-3	40,0 mm	95 mm
AG 4" - IG 2 1/2"	KI-325-2-100-4	46,0 mm	120 mm
AG 1/2" - IG 1/8"	KI-325-3-015-1/2	21,0 mm	26 mm
AG 3/4" - IG 1/4"	KI-325-3-020-3/4	24,0 mm	30 mm
AG 1" - IG 3/8"	KI-325-3-025-1	27,0 mm	35 mm
AG 5/4" - IG 1/2"	KI-325-3-032-5/4	30,0 mm	45 mm
AG 5/4" - IG 3/4"	KI-325-3-040-6/4	38,0 mm	52 mm
AG 2" - IG 1"	KI-325-3-050-2	36,0 mm	63 mm
AG 3" - IG 5/4"	KI-325-3-080-3	47,0 mm	95 mm
AG 4" - IG 2"	KI-325-3-100-4	52,0 mm	120 mm
AG 3/4" - IG 1/8"	KI-325-4-020-3/4	24,0 mm	30 mm
AG 1" - IG 1/4"	KI-325-4-025-1	27,0 mm	35 mm
AG 5/4" - IG 1/2"	KI-325-4-040-6/4	38,0 mm	52 mm
AG 2" - IG 3/4"	KI-325-4-050-2	36,0 mm	63 mm
AG 2 1/2" - IG 1"	KI-325-4-065-21/2	45,0 mm	81 mm
AG 2" - IG 1/2"	KI-325-5-050-2	36,0 mm	63 mm

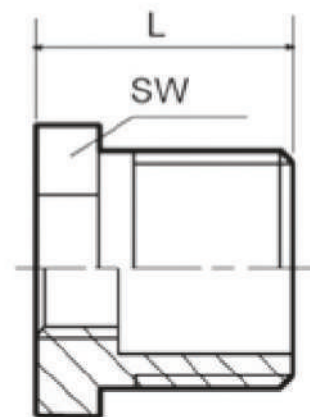

6 KT. KAPPE PN16

ISO-228-1G, 1G



Bezeichnung	Art.Nr.	L	SW
1/8"	KI-326-006	13 mm	15 mm
1/4"	KI-326-008	17 mm	18 mm
3/8"	KI-326-010	19 mm	21 mm
1/2"	KI-326-015	20 mm	27 mm
3/4"	KI-326-020	24 mm	30 mm
1"	KI-326-025	25 mm	38 mm
5/4"	KI-326-032	28 mm	50 mm
5/4"	KI-326-040	28 mm	55 mm
2"	KI-326-050	34 mm	70 mm
2 1/2"	KI-326-065	40 mm	92 mm
3"	KI-326-080	45 mm	109 mm
4"	KI-326-100	50 mm	132 mm

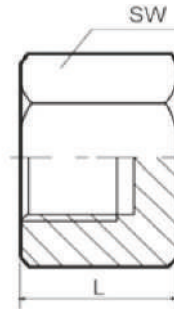

6-KT. MUTTER PN16

ISO-228-1G, 1G



Bezeichnung	Art.Nr.	L	SW
1/8"	KI-327-006	6,2 mm	14,6 mm
1/4"	KI-327-008	7,0 mm	23,0 mm
3/8"	KI-327-010	8,0 mm	26,0 mm
1/2"	KI-327-015	10,0 mm	31,0 mm
3/4"	KI-327-020	11,0 mm	37,0 mm
1"	KI-327-025	10,0 mm	46,0 mm
5/4"	KI-327-032	11,0 mm	55,0 mm
5/4"	KI-327-040	12,0 mm	63,0 mm
2"	KI-327-050	13,0 mm	76,0 mm
2 1/2"	KI-327-065	16,0 mm	95,0 mm
3"	KI-327-080	19,0 mm	105,0 mm
4"	KI-327-100	20,0 mm	131,0 mm

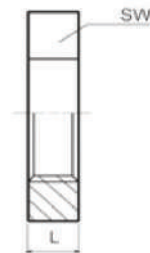



4-KT. STOPFEN PN16

EN ISO 4144, AG



Bezeichnung	Art.Nr.	L	SW
1/6"	KI-329-006	16,5 mm	6 mm
1/4"	KI-329-008	20,0 mm	9 mm
3/6"	KI-329-010	24,0 mm	11 mm
1/2"	KI-329-015	20,5 mm	13 mm
3/4"	KI-329-020	23,0 mm	16 mm
1"	KI-329-025	27,5 mm	21 mm
5/6"	KI-329-032	30,0 mm	24 mm
3/4"	KI-329-040	31,0 mm	27 mm
2"	KI-329-050	36,5 mm	34 mm
2 1/2"	KI-329-065	40,5 mm	41 mm
3"	KI-329-080	43,5 mm	46 mm
4"	KI-329-100	54,0 mm	60 mm

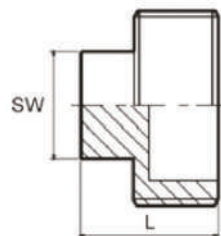

6-KT. STOPFEN PN16

EN ISO 4144, AG



Bezeichnung	Art.Nr.	L	SW
1/6"	KI-330-006	17,0 mm	12 mm
1/4"	KI-330-008	17,5 mm	16 mm
3/6"	KI-330-010	18,0 mm	20 mm
1/2"	KI-330-015	21,0 mm	24 mm
3/4"	KI-330-020	22,5 mm	30 mm
1"	KI-330-025	25,5 mm	36 mm
5/6"	KI-330-032	28,5 mm	46 mm
3/4"	KI-330-040	28,5 mm	50 mm
2"	KI-330-050	33,5 mm	65 mm
2 1/2"	KI-330-065	37,0 mm	80 mm
3"	KI-330-080	41,0 mm	95 mm
4"	KI-330-100	48,0 mm	120 mm

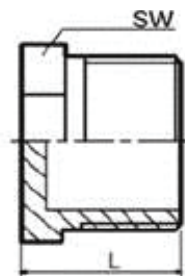



MUFFE PN16

ISO-228-1G, 1G



Bezeichnung	Art.Nr.	L	OD
1/6"	KI-333-006	18,0 mm	16,0 mm
1/4"	KI-333-008	26,0 mm	19,5 mm
3/8"	KI-333-010	27,0 mm	22,3 mm
1/2"	KI-333-015	34,0 mm	27,7 mm
3/4"	KI-333-020	36,0 mm	33,6 mm
1"	KI-333-025	43,0 mm	37,5 mm
5/4"	KI-333-032	48,0 mm	46,5 mm
3/4"	KI-333-040	48,0 mm	53,0 mm
2"	KI-333-050	56,0 mm	65,5 mm

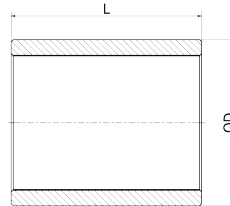

HALBE MUFFE PN16

EN ISO 4144, 1G



Bezeichnung	Art.Nr.	L	ØA
1/6"	KI-334-006	11,0 mm	16,0 mm
1/4"	KI-334-008	12,0 mm	19,5 mm
3/8"	KI-334-010	13,0 mm	22,3 mm
1/2"	KI-334-015	15,0 mm	27,7 mm
3/4"	KI-334-020	17,4 mm	33,6 mm
1"	KI-334-025	20,0 mm	39,5 mm
5/4"	KI-334-032	22,0 mm	48,3 mm
3/4"	KI-334-040	22,0 mm	54,6 mm
2"	KI-334-050	26,0 mm	66,3 mm

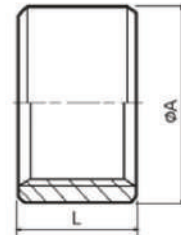



RED.-MUFFE PN16

ISO 228-1G, 1G



Bezeichnung	Art.Nr.	L	A
1/4" - 1/4"	KI-335-1-008	26,0 mm	21,5 mm
3/8" - 1/4"	KI-335-1-010	29,0 mm	26,0 mm
1/2" - 3/8"	KI-335-1-015	34,5 mm	30,0 mm
3/4" - 1/2"	KI-335-1-020	38,5 mm	36,7 mm
1" - 3/4"	KI-335-1-025	42,5 mm	44,0 mm
5/4" - 1"	KI-335-1-032	52,0 mm	52,5 mm
5/4" - 5/4"	KI-335-1-040	53,0 mm	59,7 mm
2" - 5/4"	KI-335-1-050	57,0 mm	74,7 mm
2 1/2" - 2"	KI-335-1-065	62,0 mm	85,0 mm
3" - 2 1/2"	KI-335-1-080	61,0 mm	100,0 mm
4" - 3"	KI-335-1-100	65,0 mm	128,0 mm
3/8" - 1/8"	KI-335-2-010	29,0 mm	23,0 mm
1/2" - 1/4"	KI-335-2-015	34,5 mm	30,0 mm
3/4" - 3/8"	KI-335-2-020	38,5 mm	36,0 mm
1" - 1/2"	KI-335-2-025	42,5 mm	44,0 mm
5/4" - 3/4"	KI-335-2-032	49,0 mm	52,0 mm
5/4" - 1"	KI-335-2-040	53,0 mm	59,0 mm
2" - 5/4"	KI-335-2-050	56,0 mm	72,0 mm
2 1/2" - 5/4"	KI-335-2-065	61,0 mm	85,0 mm
3" - 2"	KI-335-2-080	62,0 mm	100,0 mm
4" - 2 1/2"	KI-335-2-100	65,0 mm	128,0 mm
1/2" - 1/8"	KI-335-3-015	34,5 mm	29,0 mm
3/4" - 1/4"	KI-335-3-020	38,5 mm	36,0 mm
1" - 3/8"	KI-335-3-025	42,5 mm	44,0 mm
5/4" - 1/2"	KI-335-3-032	49,0 mm	52,0 mm
5/4" - 3/4"	KI-335-3-040	52,0 mm	59,0 mm
2" - 1"	KI-335-3-050	56,0 mm	72,0 mm
2 1/2" - 5/4"	KI-335-3-065	61,0 mm	85,0 mm
3" - 5/4"	KI-335-3-080	62,0 mm	100,0 mm
4" - 2"	KI-335-3-100	65,0 mm	128,0 mm
1" - 1/4"	KI-335-4-025	42,5 mm	43,0 mm
5/4" - 1/2"	KI-335-4-040	52,0 mm	59,0 mm
2" - 3/4"	KI-335-4-050	51,0 mm	72,0 mm
2 1/2" - 1"	KI-335-4-065	61,0 mm	87,0 mm

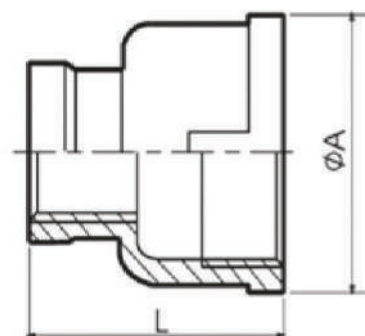



SCHLAUCHTÜLLE 6-KT. AG PN16

ISO 7-1R



Bezeichnung	Art.Nr.	ØD	L	SW
1/6"	KI-337-006-1/8-6,3	6,3 mm	45 mm	13 mm
1/4"	KI-337-008-1/4-10	10,0 mm	47 mm	16,5 mm
1/4"	KI-337-008-1/4-11	11,0 mm	47 mm	16,5 mm
1/4"	KI-337-008-1/4-12,7	12,7 mm	47 mm	16,5 mm
1/4"	KI-337-008-1/4-6,3	6,3 mm	47 mm	16,5 mm
1/4"	KI-337-008-1/4-8	8,0 mm	47 mm	16,5 mm
1/4"	KI-337-008-1/4-9	9,0 mm	47 mm	16,5 mm
3/8"	KI-337-010-3/8-10	10,0 mm	55 mm	20,0 mm
3/8"	KI-337-010-3/8-11	11,0 mm	55 mm	20,0 mm
3/8"	KI-337-010-3/8-12,7	12,7 mm	55 mm	20,0 mm
3/8"	KI-337-010-3/8-6,35	6,3 mm	55 mm	20,0 mm
3/8"	KI-337-010-3/8-8	8,0 mm	55 mm	20,0 mm
3/8"	KI-337-010-3/8-9,5	9,5 mm	55 mm	20,0 mm
1/2"	KI-337-015-1/2-10	10,0 mm	64 mm	23,5 mm
1/2"	KI-337-015-1/2-11	11,0 mm	64 mm	23,5 mm
1/2"	KI-337-015-1/2-12,7	12,7 mm	64 mm	23,5 mm
1/2"	KI-337-015-1/2-14	14,0 mm	64 mm	23,5 mm
1/2"	KI-337-015-1/2-19	19,0 mm	64 mm	23,5 mm
1/2"	KI-337-015-1/2-6,3	6,3 mm	64 mm	23,5 mm
1/2"	KI-337-015-1/2-9,5	9,5 mm	64 mm	23,5 mm
3/4"	KI-337-020-3/4-12,7	12,7 mm	68 mm	31,0 mm
3/4"	KI-337-020-3/4-19	19,0 mm	68 mm	31,0 mm
1"	KI-337-025-1-12,7	12,7 mm	71 mm	39,0 mm
1"	KI-337-025-1-19	19 mm	71 mm	39,0 mm
1"	KI-337-025-1-25,4	25,4 mm	71 mm	39,0 mm
1"	KI-337-025-1-27	27,0 mm	71 mm	39,0 mm
5/4"	KI-337-032-5/4-31,8	31,8 mm	81 mm	46,0 mm
5/4"	KI-337-032-5/4-33	33,0 mm	80 mm	46,0 mm
5/4"	KI-337-040-6/4-38	38,0 mm	81 mm	46,0 mm
5/4"	KI-337-040-6/4-39,5	39,5 mm	95 mm	52,0 mm
2"	KI-337-050-2-50,8	50,8 mm	105 mm	62,0 mm
2"	KI-337-050-2-52	52,0 mm	105 mm	62,0 mm
2 1/2"	KI-337-065-2 1/2-63,5	63,5 mm	107 mm	80,0 mm
2 1/2"	KI-337-065-2 1/2-67	67,0 mm	107 mm	80,0 mm
3"	KI-337-080-3-76	76,0 mm	112 mm	91,0 mm
3"	KI-337-080-3-80	80,0 mm	112 mm	91,0 mm
4"	KI-337-100-4-101,6	101,6 mm	130 mm	116,5 mm
4"	KI-337-100-4-105	105,0 mm	130 mm	116,5 mm

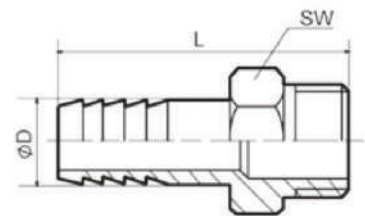



SCHLAUCHNIPPEL MIT GEWINDE PN16

ISO 7-1R



Bezeichnung (A)	Art.Nr.	D1	L	L1	L2
1/8"	KI-337G-006-1/8	8,62 mm	70 mm	30,0 mm	12 mm
1/4"	KI-337G-008-1/4	11,92 mm	70 mm	30,0 mm	12 mm
3/8"	KI-337G-010-3/8	15,62 mm	70 mm	30,0 mm	15 mm
1/2"	KI-337G-015-1/2	19,45 mm	75 mm	35,0 mm	20 mm
3/4"	KI-337G-020-3/4	25,05 mm	75 mm	35,0 mm	20 mm
1"	KI-337G-025-1	31,59 mm	80 mm	37,5 mm	20 mm
5/4"	KI-337G-032-5/4	39,76 mm	90 mm	40,0 mm	25 mm
6/4"	KI-337G-040-6/4	45,67 mm	90 mm	40,0 mm	25 mm
2"	KI-337G-050-2	57,39 mm	95 mm	40,0 mm	25 mm
2 1/2"	KI-337G-065-2 1/2	72,67 mm	105 mm	60,0 mm	30 mm
3"	KI-337G-080-3	85,23 mm	110 mm	60,0 mm	30 mm
4"	KI-337G-100-4	110,34 mm	115 mm	60,0 mm	35 mm

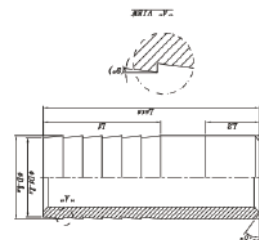

SCHLAUCHTÜLLE MIT INNENGEWINDE PN16

ISO 228-1G



Bezeichnung	Art.Nr.	ØD	L	SW
1/8"	KI-337IG-006-1/8-6,3	6,3 mm	39 mm	15 mm
1/4"	KI-337IG-008-1/4-6,3	6,3 mm	42 mm	19 mm
1/4"	KI-337IG-008-1/4-9	9 mm	42 mm	19 mm
3/8"	KI-337IG-010-3/8-9,5	9,5 mm	53 mm	22 mm
3/8"	KI-337IG-010-3/8-11	11 mm	53 mm	22 mm
1/2"	KI-337IG-015-1/2-12,7	12,7 mm	62 mm	27 mm
1/2"	KI-337IG-015-1/2-14	14 mm	62 mm	27 mm
3/4"	KI-337IG-020-3/4-19	19 mm	63,5 mm	32 mm
3/4"	KI-337IG-020-3/4-20,5	20,5 mm	63,5 mm	32 mm
1"	KI-337IG-025-1-25,4	25,4 mm	66 mm	38 mm
1"	KI-337IG-025-1-27	27 mm	66 mm	38 mm
5/4"	KI-337IG-032-5/4-31,8	31,8 mm	74 mm	50 mm
5/4"	KI-337IG-032-5/4-33	33 mm	74 mm	50 mm
6/4"	KI-337IG-040-6/4-38	38 mm	87,5 mm	55,5 mm
6/4"	KI-337IG-040-6/4-39,5	39,5 mm	87,5 mm	55,5 mm
2"	KI-337IG-050-2-50,8	50,8 mm	94,5 mm	67,5 mm
2"	KI-337IG-050-2-52	52 mm	94,5 mm	67,5 mm

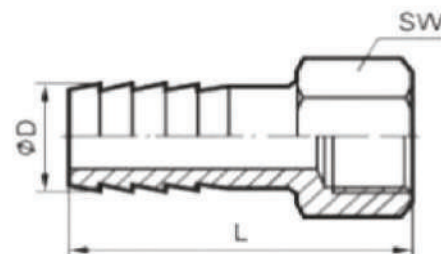

SCHLAUCHNIPPEL MIT ANSCHWEISSENDE PN16

ISO 7-1R



Bezeichnung	Art.Nr.	D1	L	L1	L2
1/8"	KI-337S-006-1/8	8,62 mm	70 mm	30,0 mm	12 mm
1/4"	KI-337S-008-1/4	11,92 mm	70 mm	30,0 mm	12 mm
3/8"	KI-337S-010-3/8	15,62 mm	70 mm	30,0 mm	15 mm
1/2"	KI-337S-015-1/2	19,45 mm	75 mm	35,0 mm	20 mm
3/4"	KI-337S-020-3/4	25,05 mm	75 mm	35,0 mm	20 mm
1"	KI-337S-025-1	31,59 mm	80 mm	37,5 mm	20 mm
5/4"	KI-337S-032-5/4	39,76 mm	90 mm	40,0 mm	25 mm
6/4"	KI-337S-040-6/4	45,67 mm	90 mm	40,0 mm	25 mm
2"	KI-337S-050-2	57,39 mm	95 mm	40,0 mm	25 mm
2 1/2"	KI-337S-065-2 1/2	72,67 mm	105 mm	60,0 mm	30 mm
3"	KI-337S-080-3	85,23 mm	110 mm	60,0 mm	30 mm
4"	KI-337S-100-4	110,34 mm	115 mm	60,0 mm	35 mm

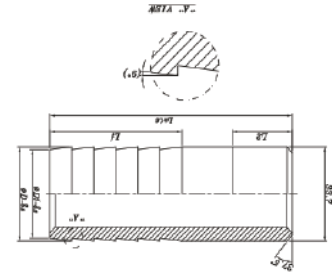

6-KT. DOPPELNIPPEL PN16

EN ISO 4144, AG



Bezeichnung	Art.Nr.	L	SW
1/8"	KI-340-006	23,6 mm	12,0 mm
1/4"	KI-340-008	27,8 mm	16,0 mm
3/8"	KI-340-010	28,0 mm	19,0 mm
1/2"	KI-340-015	34,0 mm	21,6 mm
3/4"	KI-340-020	40,0 mm	30,0 mm
1"	KI-340-025	46,0 mm	36,0 mm
5/4"	KI-340-032	52,5 mm	46,0 mm
6/4"	KI-340-040	54,0 mm	50,0 mm
2"	KI-340-050	62,0 mm	64,5 mm
2 1/2"	KI-340-065	70,0 mm	79,5 mm
3"	KI-340-080	78,4 mm	90,0 mm
4"	KI-340-100	94,0 mm	120,0 mm

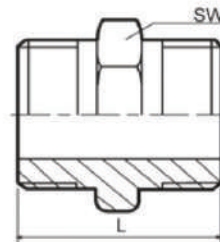



6-KT.RED.DOPPELNIPPEL PN16

EN ISO 4144, AG - AG



Bezeichnung	Art.Nr.	L	SW
1/4" - 1/8"	KI-341-1-008	25,5 mm	16 mm
3/8" - 1/4"	KI-341-1-010	28,5 mm	18 mm
1/2" - 3/8"	KI-341-1-015	32,5 mm	24 mm
3/4" - 1/2"	KI-341-1-020	38,0 mm	30 mm
1" - 3/4"	KI-341-1-025	42,0 mm	36 mm
5/4" - 1"	KI-341-1-032	48,5 mm	46 mm
5/4" - 5/4"	KI-341-1-040	51,0 mm	50 mm
2" - 5/4"	KI-341-1-050	55,5 mm	65 mm
2 1/2" - 2"	KI-341-1-065	62,0 mm	80 mm
3" - 2 1/2"	KI-341-1-080	68,0 mm	95 mm
4" - 3"	KI-341-1-100	77,0 mm	120 mm
3/8" - 1/8"	KI-341-2-010	26,0 mm	18 mm
1/2" - 1/4"	KI-341-2-015	32,0 mm	24 mm
3/4" - 3/8"	KI-341-2-020	34,5 mm	30 mm
1" - 1/2"	KI-341-2-025	41,0 mm	36 mm
5/4" - 3/4"	KI-341-2-032	45,5 mm	46 mm
5/4" - 1"	KI-341-2-040	48,5 mm	50 mm
2" - 5/4"	KI-341-2-050	55,5 mm	65 mm
2 1/2" - 5/4"	KI-341-2-065	57,5 mm	80 mm
3" - 2"	KI-341-2-080	66,0 mm	95 mm
4" - 2 1/2"	KI-341-2-100	74,0 mm	120 mm
1/2" - 1/8"	KI-341-3-015	34,0 mm	26 mm
3/4" - 1/4"	KI-341-3-020	37,0 mm	30 mm
1" - 3/8"	KI-341-3-025	40,0 mm	35 mm
5/4" - 1/2"	KI-341-3-032	48,0 mm	46 mm
5/4" - 3/4"	KI-341-3-040	53,0 mm	50 mm
2" - 1"	KI-341-3-050	57,0 mm	63 mm
3" - 5/4"	KI-341-3-080	72,0 mm	95 mm
4" - 2"	KI-341-3-100	82,0 mm	125 mm
3/4" - 1/8"	KI-341-4-020	37,0 mm	30 mm
1" - 1/4"	KI-341-4-025	39,0 mm	35 mm
5/4" - 1/2"	KI-341-4-040	49,0 mm	50 mm
2" - 3/4"	KI-341-4-050	56,0 mm	63 mm
2 1/2" - 1"	KI-341-4-065	63,0 mm	80 mm

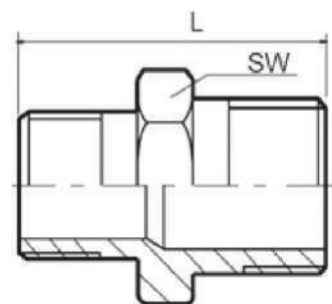

MUFFENNIPPEL 1-STUFIG IG/AG PN16

ISO 228-1G



Bezeichnung	Art.Nr.	L	SW
IG 1/4" - AG 1/8"	KI-342-1-008	27,0 mm	17 mm
IG 3/8" - AG 1/4"	KI-342-1-010	30,5 mm	21 mm
IG 1/2" - AG 3/8"	KI-342-1-015	34,5 mm	26 mm
IG 3/4" - AG 1/2"	KI-342-1-020	38,5 mm	32 mm
IG 1" - AG 3/4"	KI-342-1-025	44,0 mm	38 mm
IG 3/4" - AG 1"	KI-342-1-032	47,0 mm	50 mm
IG 5/8" - AG 3/4"	KI-342-1-040	50,0 mm	54 mm
IG 2" - AG 3/4"	KI-342-1-050	54,0 mm	68 mm

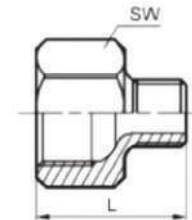

MUFFENNIPPEL 2-STUFIG IG/AG PN16

ISO 228-1G



Bezeichnung	Art.Nr.	L	SW
IG 3/8" - AG 1/8"	KI-342-2-010	29,0 mm	21 mm
IG 1/2" - AG 1/4"	KI-342-2-015	34,0 mm	26 mm
IG 3/4" - AG 3/8"	KI-342-2-020	35,5 mm	32 mm
IG 1" - AG 1/2"	KI-342-2-025	41,0 mm	38 mm
IG 5/8" - AG 3/4"	KI-342-2-032	45,0 mm	50 mm
IG 3/4" - AG 1"	KI-342-2-040	48,0 mm	54 mm
IG 2" - AG 3/4"	KI-342-2-050	53,0 mm	68 mm

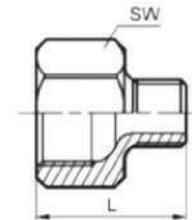

MUFFENNIPPEL 3-STUFIG IG/AG PN16

ISO 228-1G



Bezeichnung	Art.Nr.	L	SW
IG 1/2" - AG 1/8"	KI-342-3-015	32,5 mm	26 mm
IG 3/4" - AG 1/4"	KI-342-3-020	35,0 mm	32 mm
IG 1" - AG 3/8"	KI-342-3-025	38,5 mm	38 mm
IG 5/8" - AG 1/2"	KI-342-3-032	42,5 mm	50 mm
IG 3/4" - AG 3/4"	KI-342-3-040	46,0 mm	54 mm
IG 2" - AG 1"	KI-342-3-050	51,0 mm	68 mm

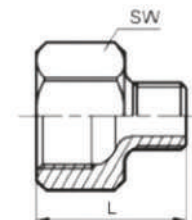

ADAPTER IG BSP-AG NPT PN16

ISO 228-1G/NPT



Bezeichnung	Art.Nr.	L	SW
IG 1/4" BSP - AG 1/4" NPT	KI-342-BSP-NPT-006	26,0 mm	15 mm
IG 1/4" BSP - AG 1/4" NPT	KI-342-BSP-NPT-008	28,5 mm	17 mm
IG 3/8" BSP - AG 3/8" NPT	KI-342-BSP-NPT-010	31,0 mm	21 mm
IG 1/2" BSP - AG 1/2" NPT	KI-342-BSP-NPT-015	37,5 mm	26 mm
IG 3/4" BSP - AG 3/4" NPT	KI-342-BSP-NPT-020	41,0 mm	32 mm
IG 1" BSP - AG 1" NPT	KI-342-BSP-NPT-025	46,0 mm	38 mm
IG 1 1/4" BSP - AG 1 1/4" NPT	KI-342-BSP-NPT-032	49,0 mm	50 mm
IG 1 1/2" BSP - AG 1 1/2" NPT	KI-342-BSP-NPT-040	51,0 mm	54 mm
IG 2" BSP - AG 2" NPT	KI-342-BSP-NPT-050	57,0 mm	68 mm

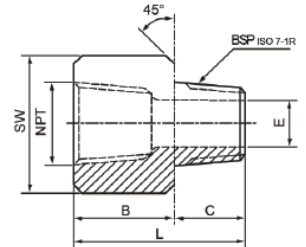

ADAPTER IG NPT-AG BSP PN16

NPT/ISO 7-1R



Bezeichnung	Art.Nr.	L	SW
IG 1/4" NPT - AG 1/4" BSP	KI-342-NPT-BSP-006	26,0 mm	15 mm
IG 1/4" NPT - AG 1/4" BSP	KI-342-NPT-BSP-008	28,5 mm	17 mm
IG 3/8" NPT - AG 3/8" BSP	KI-342-NPT-BSP-010	31,0 mm	21 mm
IG 1/2" NPT - AG 1/2" BSP	KI-342-NPT-BSP-015	37,5 mm	26 mm
IG 3/4" NPT - AG 3/4" BSP	KI-342-NPT-BSP-020	41,0 mm	32 mm
IG 1" NPT - AG 1" BSP	KI-342-NPT-BSP-025	46,0 mm	38 mm
IG 1 1/4" NPT - AG 1 1/4" BSP	KI-342-NPT-BSP-032	49,0 mm	50 mm
IG 1 1/2" NPT - AG 1 1/2" BSP	KI-342-NPT-BSP-040	51,0 mm	54 mm
IG 2" NPT - AG 2" BSP	KI-342-NPT-BSP-050	57,0 mm	68 mm

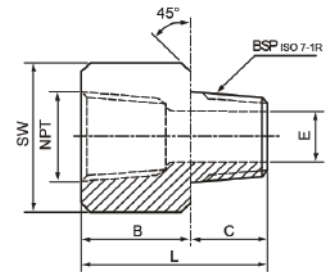

BEHÄLTERVERSCHRAUBUNGEN



Bezeichnung	Art.Nr.	L	A	B	C	D	SW
IG 1/2" - AG 3/4"	BVSR-015-020	55,5 mm	33,7 mm	41,7 mm	52 mm	47,6 mm	36 mm
IG 3/4" - AG 1"	BVSR-020-025	56,0 mm	31,5 mm	47,3 mm	50 mm	52,8 mm	42 mm
IG 1" - AG 3/4"	BVSR-025-032	56,0 mm	31,5 mm	54,8 mm	70 mm	67,3 mm	53 mm
IG 3/4" - AG 3/4"	BVSR-032-040	56,0 mm	29,5 mm	65,5 mm	76 mm	74,0 mm	61 mm
IG 3/4" - AG 2"	BVSR-040-050	55,0 mm	29,5 mm	80,2 mm	88 mm	86,5 mm	74 mm

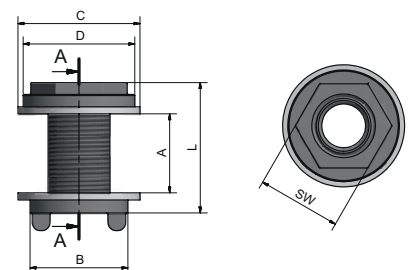

GEWINDEFITTINGS P40 - PN100

- » Material V4A (1.4404/1.4571)
- » hochwertige genormte Gewindefittings
- » hohe Druckbeständigkeit
- » CAD-Zeichnung verfügbar
- » Materialzertifikat 3.1 verfügbar
- » Einzelteile bei Verschraubungen austauschbar





1/8" 1/4" 3/8" 1/2" 3/4" 1" 1 1/4" 1 1/2" 2" 2 1/2" 3" 4"

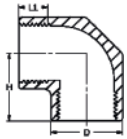

WINKEL 90° IG/IG

Art.Nr.: NF-301

H	19 mm	21 mm	25 mm	28 mm	34 mm	38 mm	45 mm	50 mm	58 mm	75 mm	80 mm
Druck	100 bar	100 bar	100 bar	100 bar	100 bar	100 bar	64 bar	64 bar	64 bar	40 bar	40 bar

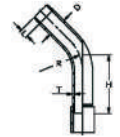

BOGEN 45° IG/AG

Art.Nr.: NF-305-045

H	45 mm	50 mm	60 mm	65 mm	85 mm	100 mm	115 mm	135 mm	160 mm	200 mm	240 mm
Druck	100 bar	100 bar	100 bar	100 bar	100 bar	100 bar	64 bar	64 bar	64 bar	40 bar	40 bar

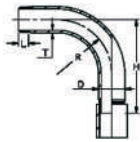

BOGEN 90° IG/AG

Art.Nr.: NF-305

H	50 mm	60 mm	70 mm	80 mm	100 mm	120 mm	140 mm	160 mm	190 mm	240 mm	290 mm
Druck	100 bar	100 bar	100 bar	100 bar	100 bar	100 bar	64 bar	64 bar	64 bar	40 bar	40 bar

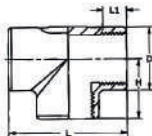

T-STÜCK EGAL

Art.Nr.: NF-307

L	38 mm	42 mm	50 mm	56 mm	67,5 mm	76 mm	90 mm	100 mm	116 mm	150 mm	160 mm
H	19 mm	21 mm	25 mm	28 mm	34 mm	38 mm	45 mm	50 mm	58 mm	75 mm	80 mm
Druck	100 bar	100 bar	100 bar	100 bar	100 bar	100 bar	64 bar	64 bar	64 bar	40 bar	40 bar

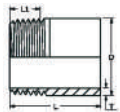

ANSCHWEISS-NIPPEL

Art.Nr.: NF-308
aus geschw. Rohr gefertigt

L	30 mm	30 mm	30 mm	45 mm	40 mm	40 mm	50 mm	50 mm	55 mm	60 mm	65 mm	90 mm
Druck	100 bar	100 bar	100 bar	100 bar	100 bar	100 bar	64 bar	64 bar	64 bar	40 bar	40 bar	40 bar

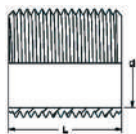

ROHRNIPPEL

Art.Nr.: NF-309
durchgehendes AG, ISO 228/1 zyl.

L	16 mm	18 mm	22 mm	25 mm	30 mm	35 mm	38 mm	38 mm	45 mm	55 mm	60 mm
Druck	100 bar	100 bar	100 bar	100 bar	100 bar	100 bar	64 bar	64 bar	64 bar	40 bar	40 bar

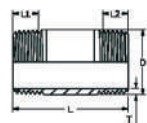

ROHRDOPPEL-NIPPEL

Art.Nr.: NF-310
aus geschw. Rohr gefertigt

L	40 mm	40 mm	40 mm	60 mm	60 mm	60 mm	80 mm	80 mm	100 mm	100 mm	120 mm	150 mm
Druck	100 bar	100 bar	100 bar	100 bar	100 bar	100 bar	64 bar	64 bar	64 bar	40 bar	40 bar	40 bar

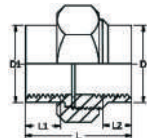

VERSCHRAUBUNG IG/IG

Art.Nr.: NF-311
flach dichtend

L	32 mm	32 mm	38 mm	41 mm	47 mm	53 mm	58 mm	63 mm	72 mm	80 mm	80 mm
Druck	100 bar	100 bar	100 bar	100 bar	100 bar	100 bar	64 bar	64 bar	64 bar	40 bar	40 bar

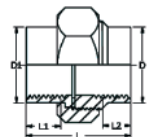

VERSCHRAUBUNG IG/IG

Art.Nr.: NF-3110
mit O-Ring Dichtung

L	38 mm	41 mm	47 mm	53 mm	58 mm	63 mm	72 mm	72 mm
Druck	100 bar	100 bar	100 bar	100 bar	64 bar	64 bar	64 bar	64 bar

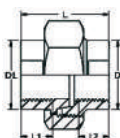

VERSCHRAUBUNG IG/IG

Art.Nr.: NF-312
konisch dichtend

L	32 mm	38 mm	41 mm	46 mm	50 mm	56 mm	62 mm	64 mm	67 mm	70 mm	75 mm
Druck	100 bar	100 bar	100 bar	100 bar	100 bar	100 bar	64 bar	64 bar	64 bar	40 bar	40 bar

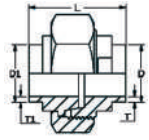

**VERSCHRAUBUNG
AE/AE**

Art.Nr.: NF-313
konisch dichtend

	1/8"	1/4"	3/8"	1/2"	3/4"	1"	1 1/4"	1 1/2"	2"	2 1/2"	3"	4"
L		38 mm	40 mm	40 mm	44 mm	53 mm	57 mm	63 mm	74 mm	83 mm		
Druck		100 bar	100 bar	100 bar	100 bar	100 bar	64 bar	64 bar	64 bar	64 bar		

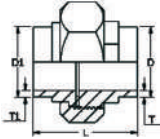

**VERSCHRAUBUNG
AE/AE**

Art.Nr.: NF-314
flach dichtend

L		38 mm	40 mm	40 mm	44 mm	53 mm	57 mm	63 mm	74 mm			
Druck		100 bar	100 bar	100 bar	100 bar	100 bar	64 bar	64 bar	64 bar			

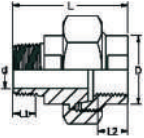

**VERSCHRAUBUNG
IG/AG**

Art.Nr.: NF-315
konisch dichtend

L	40,5 mm	47 mm	53 mm	62 mm	66 mm	74 mm	81 mm	84 mm	87 mm	97 mm	109 mm
Druck	100 bar	100 bar	100 bar	100 bar	100 bar	100 bar	64 bar	64 bar	64 bar	40 bar	40 bar

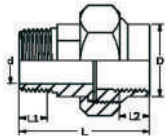

**VERSCHRAUBUNG
IG/AG**

Art.Nr.: NF-316
flach dichtend

L	42 mm	42 mm	49 mm	56 mm	63 mm	69 mm	74 mm	80 mm	87 mm	101 mm	101 mm
Druck	100 bar	100 bar	100 bar	100 bar	100 bar	100 bar	64 bar	64 bar	64 bar	40 bar	40 bar

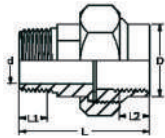

**VERSCHRAUBUNG
IG/AG**

Art.Nr.: NF-316D
mit O-Ring Dichtung

L		42 mm	49 mm	56 mm	63 mm	69 mm	74 mm	80 mm	87 mm		
Druck		100 bar	100 bar	100 bar	100 bar	100 bar	64 bar	64 bar	64 bar		

**RED.-STÜCK
6-KNT.**

Art.Nr.: NF-325

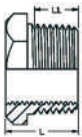

	1/4" x 1/8"	3/8" x 1/8"	3/8" x 1/4"	1/2" x 1/8"	1/2" x 1/4"	1/2" x 3/8"	3/4" x 1/4"	3/4" x 3/8"	3/4" x 1/2"
L	17 mm	17,5 mm	17,5 mm	21 mm	21 mm	21 mm	24,5 mm	24,5 mm	24,5 mm
Druck	100 bar	100 bar	100 bar	100 bar	100 bar	100 bar	100 bar	100 bar	100 bar

	1" x 1/4"	1" x 3/8"	1" x 1/2"	1" x 3/4"	1 1/4" x 1/2"	1 1/4" x 3/4"	1 1/4" x 1"	1 1/2" x 1/2"	1 1/2" x 3/4"
L	27 mm	27 mm	27 mm	27 mm	32,5 mm	32,5 mm	32,5 mm	32,5 mm	32,5 mm
Druck	100 bar	100 bar	100 bar	100 bar	100 bar	64 bar	64 bar	64 bar	64 bar

	1 1/2" x 1"	1 1/2" x 1 1/4"	2" x 1"	2" x 1 1/4"	2" x 1 1/2"	2 1/2" x 2"	3" x 2"	3" x 2 1/2"
L	32,5 mm	32,5 mm	40 mm	40 mm	40 mm	46 mm	51,5 mm	51,5 mm
Druck	64 bar	64 bar	64 bar	64 bar	64 bar	40 bar	40 bar	40 bar



1/8" 1/4" 3/8" 1/2" 3/4" 1" 1 1/4" 1 1/2" 2" 2 1/2" 3" 4"

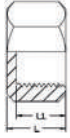

KAPPE 6-KNT.
Art.Nr.: NF-326

L	13 mm	17 mm	18 mm	22 mm	24 mm	28 mm	30 mm	31 mm	35 mm	40 mm	45 mm
Druck	100 bar	100 bar	100 bar	100 bar	100 bar	100 bar	64 bar	64 bar	64 bar	40 bar	40 bar



MUTTER 6-KNT.
Art.Nr.: NF-327

L	13 mm	17 mm	18 mm	22 mm	24 mm	28 mm	30 mm	31 mm	35 mm	40 mm	45 mm
Druck	100 bar	100 bar	100 bar	100 bar	100 bar	100 bar	64 bar	64 bar	64 bar	40 bar	40 bar

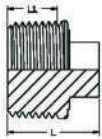

STOPFEN 4-KNT.
mit kon. AG
Art.Nr.: NF-329

L	16 mm	18 mm	20 mm	22 mm	27 mm	32 mm	36 mm	37 mm	43 mm	46 mm	50 mm
Druck	100 bar	100 bar	100 bar	100 bar	100 bar	100 bar	64 bar	64 bar	64 bar	40 bar	40 bar

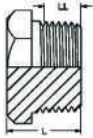

STOPFEN 6-KNT.
Art.Nr.: NF-330
mit kon. AG

L	14 mm	17 mm	17 mm	21 mm	24 mm	27 mm	32 mm	33 mm	38 mm	45 mm	48 mm
Druck	100 bar	100 bar	100 bar	100 bar	100 bar	100 bar	64 bar	64 bar	64 bar	40 bar	40 bar

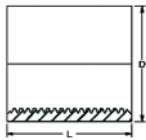

MUFFE
Art.Nr.: NF-333
Bauform n. 2986, Gewinde n. ISO 228/1 zyl.

L	17 mm	25 mm	26 mm	34 mm	36 mm	43 mm	48 mm	48 mm	56 mm	65 mm	71 mm	85 mm
Druck	100 bar	100 bar	100 bar	100 bar	100 bar	100 bar	64 bar	64 bar	64 bar	40 bar	40 bar	40 bar

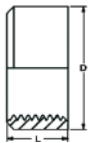

HALBE MUFFE
Art.Nr.: NF-334
Bauform n. 2986, Gewinde n. ISO 228/1 zyl.

L	10 mm	10 mm	12 mm	15 mm	17 mm	19,5 mm	22 mm	22 mm	26 mm	30,5 mm	34 mm
Druck	100 bar	100 bar	100 bar	100 bar	100 bar	100 bar	64 bar	64 bar	64 bar	40 bar	40 bar

REDUKTIONS-MUFFE

Art.Nr.: NF-335
Bauform n. 2986
Gewinde n. ISO 228/1 zyl.

1/4" x 1/8" 3/8" x 1/4" 1/2" x 1/4" 1/2" x 3/8" 3/4" x 3/8" 3/4" x 1/2" 1" x 1/2" 1" x 3/4" 1 1/4" x 1/2"

L	27 mm	30 mm	36 mm	36 mm	39 mm	39 mm	45 mm	45 mm	52 mm
Druck	100 bar	100 bar	100 bar	100 bar	100 bar	100 bar	100 bar	100 bar	64 bar

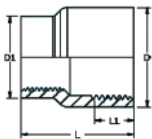

1 1/4" x 3/4" 1 1/4" x 1" 1 1/2" x 3/4" 1 1/2" x 1" 1 1/2" x 1 1/4" 2" x 1" 2" x 1 1/4" 2" x 1 1/2" 2 1/2" x 2"

L	50 mm	50 mm	55 mm	55 mm	55 mm	65 mm	65 mm	65 mm	74 mm
Druck	64 bar	64 bar	64 bar	64 bar	64 bar	64 bar	64 bar	64 bar	40 bar

3" x 2" 3" x 2 1/2"

L	78 mm	80 mm
Druck	40 bar	40 bar



1/8" 1/4" 3/8" 1/2" 3/4" 1" 1 1/4" 1 1/2" 2" 2 1/2" 3" 4"

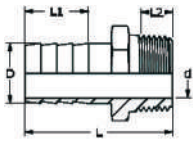

**SCHLAUCHTÜLLE
AG 6-KNT.**

Art.Nr.: NF-337

L	36 mm	40 mm	42 mm	48 mm	56 mm	65 mm	75 mm	78 mm	96 mm
Druck	100 bar	100 bar	100 bar	100 bar	100 bar	100 bar	64 bar	64 bar	64 bar

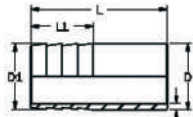

**SCHLAUCHNIPPEL
AE**

Art.Nr.: NF-337S

L	36 mm	40 mm	42 mm	48 mm	56 mm	65 mm	75 mm	78 mm	96 mm
Druck	100 bar	100 bar	100 bar	100 bar	100 bar	100 bar	64 bar	64 bar	64 bar

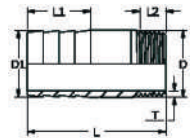

**SCHLAUCHNIPPEL
AG**

Art.Nr.: NF-337G

L	70 mm	70 mm	70 mm	70 mm	70 mm	70 mm	100 mm	100 mm
Druck	100 bar	100 bar	100 bar	100 bar	100 bar	64 bar	64 bar	64 bar

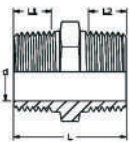

**DOPPELNIPPEL
6-KNT.**

Art.Nr.: NF-340

L	21 mm	28 mm	29 mm	36 mm	41 mm	46,5 mm	54 mm	54 mm	65,5 mm	76,5 mm	85 mm	94 mm
Druck	100 bar	100 bar	100 bar	100 bar	100 bar	100 bar	64 bar	64 bar	64 bar	40 bar	40 bar	40 bar

**DOPPELNIPPEL
6-KNT. RED.**

Art.Nr.: NF-341

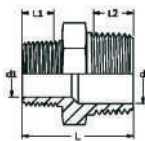

1/4" x 1/8" 3/8" x 1/8" 3/8" x 1/4" 1/2" x 1/8" 1/2" x 1/4" 1/2" x 3/8" 3/4" x 1/4" 3/4" x 3/8" 3/4" x 1/2"

L	25 mm	25,5 mm	29 mm	30 mm	33 mm	33,5 mm	37 mm	37 mm	40,5 mm
Druck	100 bar	100 bar	100 bar	100 bar	100 bar	100 bar	100 bar	100 bar	100 bar

1" x 1/4" 1" x 3/8" 1" x 1/2" 1" x 3/4" 1 1/4" x 1/2" 1 1/4" x 3/4" 1 1/4" x 1" 1 1/2" x 1/2" 1 1/2" x 3/4"

L	40 mm	40,5 mm	44 mm	45,5 mm	48 mm	49,5 mm	52 mm	48 mm	49 mm
Druck	100 bar	100 bar	100 bar	100 bar	100 bar	64 bar	64 bar	64 bar	64 bar

1 1/2" x 1" 1 1/2" x 1 1/4" 2" x 1" 2" x 1 1/4" 2" x 1 1/2" 2 1/2" x 3/4" 2 1/2" x 2" 3" x 2" 3" x 2 1/2"

L	52 mm	54 mm	59 mm	62 mm	62 mm	63 mm	73 mm	78 mm	82 mm
Druck	64 bar	64 bar	64 bar	64 bar	64 bar	40 bar	40 bar	40 bar	40 bar

SCHNEIDERINGVERSCHRAUBUNGEN

- » für Hochdruckanwendungen, z.B.: Hydraulik, Pneumatik
- » Rohrverschraubungen mit Schneidring werden nach DIN 2353 gefertigt
- » Material: V4A (1.4571)
- » zulässiger Betriebsdruck: abhängig von Dimension - bis zu PN400
- » metallisch dichtend, tottraumarm
- » Größere Dimensionen, Verschraubungen für höheren Druck, andere Formstücke, Absperrhähne etc. jederzeit lieferbar
- » **Achtung:** Montageanleitung beachten!

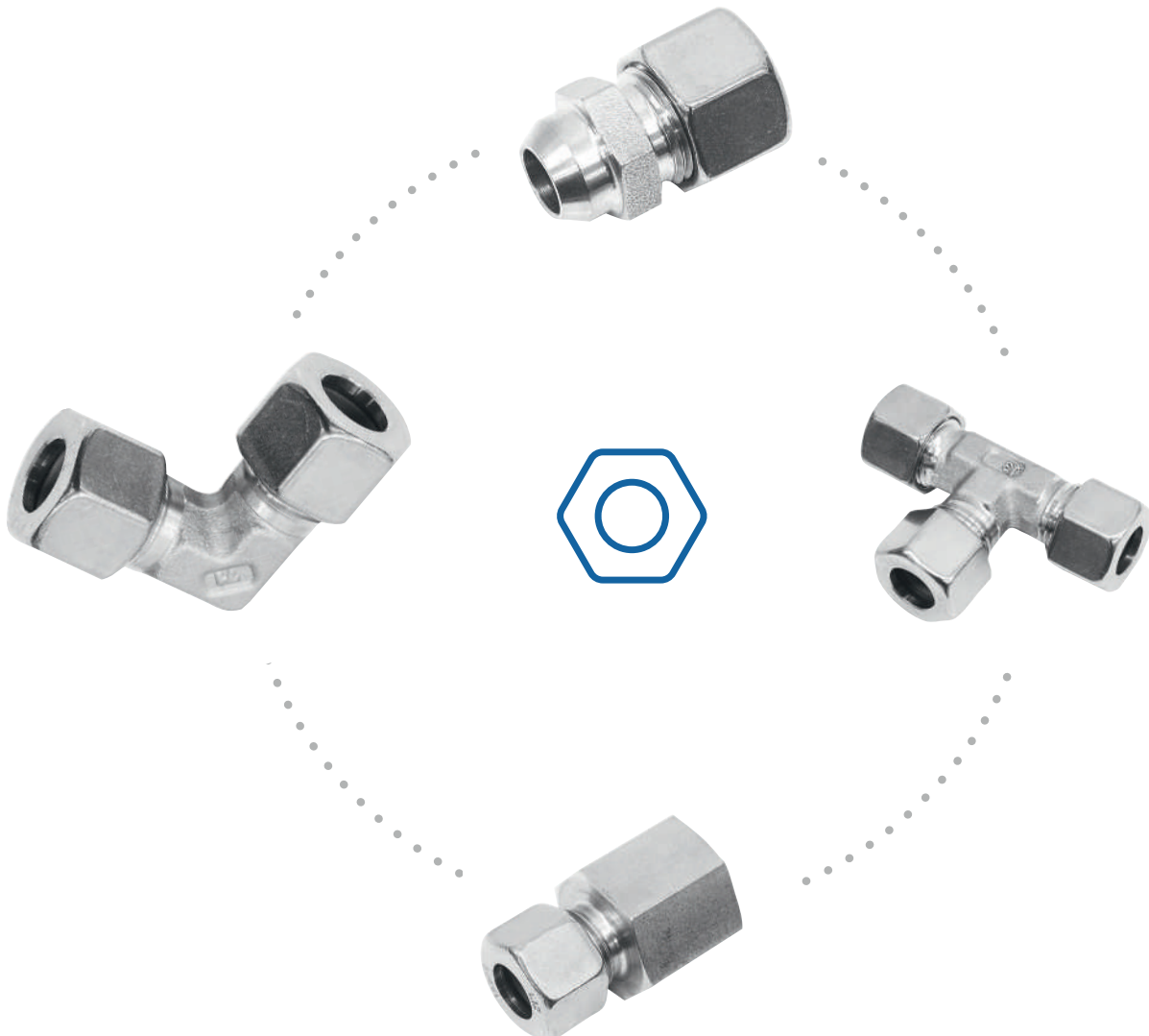

VERSCHRAUBUNG

GERADE

Material: V4A

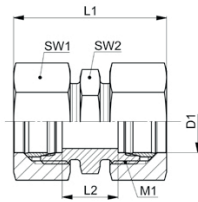

DN	Art.Nr.	M1	L1	L2	SW1	SW2	Gewicht
6 mm	DL06A	12 x 1,5 mm	40 mm	10 mm	14 mm	12 mm	35 g
8 mm	DL08A	14 x 1,5 mm	41 mm	11 mm	17 mm	14 mm	50 g
10 mm	DL10A	16 x 1,5 mm	44 mm	13 mm	19 mm	17 mm	65 g
12 mm	DL12A	18 x 1,5 mm	45 mm	14 mm	22 mm	19 mm	85 g
15 mm	DL15A	22 x 1,5 mm	48 mm	16 mm	27 mm	24 mm	140 g
18 mm	DL18A	26 x 1,5 mm	50 mm	16 mm	32 mm	27 mm	201 g
22 mm	DL22A	30 x 2,0 mm	54 mm	20 mm	36 mm	32 mm	274 g
28 mm	DL28A	36 x 2,0 mm	55 mm	21 mm	41 mm	41 mm	347 g

WINKELVERSCHRAUBUNG

Material: V4A

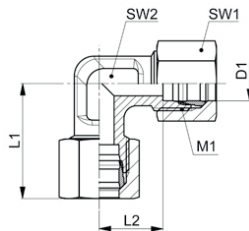

DN	Art.Nr.	M1	L1	L2	SW1	SW2	Gewicht
6 mm	EL06A	12 x 1,5 mm	27,0 mm	12,0 mm	14 mm	12 mm	42 g
8 mm	EL08A	14 x 1,5 mm	29,0 mm	14,0 mm	17 mm	12 mm	59 g
10 mm	EL10A	16 x 1,5 mm	30,5 mm	15,0 mm	19 mm	14 mm	74 g
12 mm	EL12A	18 x 1,5 mm	32,5 mm	17,0 mm	22 mm	17 mm	103 g
15 mm	EL15A	22 x 1,5 mm	37,0 mm	21,0 mm	27 mm	19 mm	169 g
18 mm	EL18A	26 x 1,5 mm	40,5 mm	23,5 mm	32 mm	24 mm	248 g
22 mm	EL22A	30 x 2,0 mm	44,5 mm	27,5 mm	36 mm	27 mm	320 g
28 mm	EL28A	36 x 2,0 mm	47,5 mm	30,5 mm	41 mm	36 mm	454 g

T-VERSCHRAUBUNG

Material: V4A

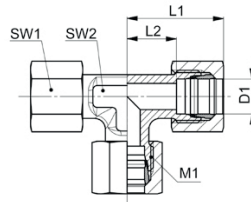

DN	Art.Nr.	M1	L1	L2	SW1	SW2	Gewicht
6 mm	TL06A	12 x 1,5 mm	27,0 mm	12,0 mm	14 mm	12 mm	51 g
8 mm	TL08A	14 x 1,5 mm	29,0 mm	14,0 mm	17 mm	12 mm	85 g
10 mm	TL10A	16 x 1,5 mm	30,5 mm	15,0 mm	19 mm	14 mm	106 g
12 mm	TL12A	18 x 1,5 mm	32,5 mm	17,0 mm	22 mm	17 mm	140 g
15 mm	TL15A	22 x 1,5 mm	37,0 mm	21,0 mm	27 mm	19 mm	240 g
18 mm	TL18A	26 x 1,5 mm	40,5 mm	23,5 mm	32 mm	24 mm	348 g
22 mm	TL22A	30 x 2,0 mm	44,5 mm	27,5 mm	36 mm	27 mm	468 g
28 mm	TL28A	36 x 2,0 mm	47,5 mm	30,5 mm	41 mm	36 mm	665 g

ANSCHWEISSVERSCHRAUBUNG

GERADE

Material: V4A

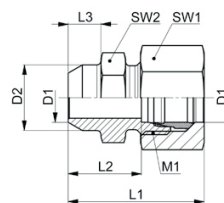

DN	Art.Nr.	M1	D2	L1	L2	L3	SW1	SW2	Gewicht
6 mm	ASL06A	12 x 1,5	10 mm	29 mm	14 mm	7 mm	14 mm	12 mm	25 g
8 mm	ASL08A	14 x 1,5	12 mm	31 mm	16 mm	8 mm	17 mm	14 mm	36 g
10 mm	ASL10A	16 x 1,5	14 mm	33 mm	18 mm	8 mm	19 mm	17 mm	47 g
12 mm	ASL12A	18 x 1,5	16 mm	33 mm	18 mm	8 mm	22 mm	19 mm	55 g
15 mm	ASL15A	22 x 1,5	19 mm	37 mm	22 mm	10 mm	27 mm	22 mm	90 g
18 mm	ASL18A	26 x 1,5	22 mm	40 mm	23,5 mm	10 mm	32 mm	27 mm	130 g
22 mm	ASL22A	30 x 2,0	27 mm	45 mm	28,5 mm	12 mm	36 mm	32 mm	190 g
28 mm	ASL28A	36 x 2,0	32 mm	47 mm	30,5 mm	12 mm	41 mm	41 mm	270 g

AUFSCRAUBVERSCHRAUBUNG

GERADE

Material: V4A

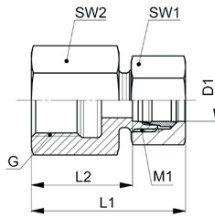

DN / G	Art.Nr.	M1	L1	L2	SW1	SW2	Gewicht
6 mm / ¼"	GAIL06R14A	12 x 1,5 mm	39 mm	24,0 mm	14 mm	19 mm	48 g
8 mm / ¼"	GAIL08R14A	14 x 1,5 mm	39 mm	24,0 mm	17 mm	19 mm	50 g
10 mm / ½"	GAIL10R12A	16 x 1,5 mm	45 mm	30,0 mm	19 mm	27 mm	102 g
12 mm / ½"	GAIL12R12A	18 x 1,5 mm	45 mm	30,0 mm	22 mm	27 mm	106 g
15 mm / ½"	GAIL15R12A	22 x 1,5 mm	46 mm	31,0 mm	27 mm	27 mm	113 g
18 mm / ¾"	GAIL18R38A	26 x 1,5 mm	43 mm	26,5 mm	32 mm	27 mm	168 g
22 mm / ¾"	GAIL22R34A	30 x 2,0 mm	52 mm	35,5 mm	36 mm	36 mm	270 g
28 mm / 1"	GAIL28R1A	36 x 2,0 mm	55 mm	38,0 mm	41 mm	41 mm	311 g

Whitworth-Rohrgewinde zylindrisch, andere Gewindeanschlüsse auf Anfrage!

EINSCHRAUBVERSCHRAUBUNG

GERADE

Material: V4A

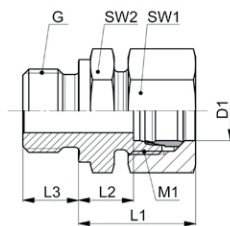

DN / G	Art.Nr.	M1	L1	L2	L3	SW1	SW2	Gewicht
6 mm / ¼"	AL06R14A	12 x 1,5 mm	25 mm	10,0 mm	12 mm	14 mm	19 mm	40 g
8 mm / ¼"	AL08R14A	15 x 1,5 mm	25 mm	10,0 mm	12 mm	17 mm	19 mm	43 g
10 mm / ½"	AL10R12A	16 x 1,5 mm	29 mm	14,0 mm	14 mm	19 mm	27 mm	102 g
12 mm / ½"	AL12R12A	18 x 1,5 mm	28 mm	13,0 mm	14 mm	22 mm	27 mm	101 g
15 mm / ½"	AL15R12A	22 x 1,5 mm	29 mm	14,0 mm	14 mm	27 mm	27 mm	114 g
18 mm / ¾"	AL18R38A	26 x 1,5 mm	31 mm	14,5 mm	12 mm	32 mm	27 mm	136 g
22 mm / ¾"	AL22R34A	30 x 2,0 mm	33 mm	16,5 mm	16 mm	36 mm	32 mm	196 g
28 mm / 1"	AL28R1A	36 x 2,0 mm	34 mm	17,5 mm	18 mm	41 mm	41 mm	270 g

Whitworth-Rohrgewinde zylindrisch, andere Gewindeanschlüsse auf Anfrage!

HOCHDRUCK RÜCKSCHLAGVENTIL

Material: V4A, Dichtung: FKM
Öffnungsdruck: 1 Bar

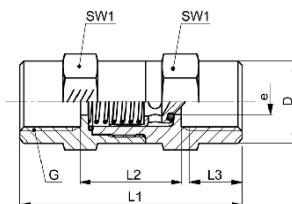

DN (G)	Art.Nr.	D	L1	L2	L3	SW1	e	Gewicht
1/4"	RVHD-006-1/8	17 mm	42,5 mm	10 mm	8 mm	17 mm	4 mm	60 g
1/4"	RVHD-008-1/4	19 mm	51,0 mm	14 mm	12 mm	19 mm	6 mm	81 g
1/2"	RVHD-015-1/2	30 mm	72,0 mm	18 mm	14 mm	30 mm	11 mm	266 g
3/4"	RVHD-020-3/4	36 mm	84,0 mm	20 mm	16 mm	36 mm	14 mm	450 g
1"	RVHD-025-1	46 mm	95,0 mm	23 mm	18 mm	46 mm	18 mm	817 g
1 1/4"	RVHD-032-5/4	50 mm	110,0 mm	25 mm	20 mm	50 mm	24 mm	920 g
1 1/2"	RVHD-040-6/4	60 mm	114,0 mm	27 mm	22 mm	60 mm	28 mm	1436 g

REDUZIERVERSCHRAUBUNG

GERADE

Material: V4A

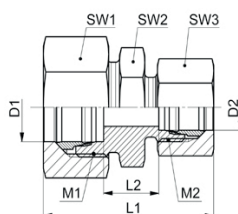

DN	Art.Nr.	M1	M2	L1	L2	SW1	SW2	SW3	Gewicht
8 / 6 mm	DLR0806A	14 x 1,5	12 x 1,5	41 mm	11 mm	17 mm	14 mm	14 mm	51 g
10 / 6 mm	DLR1006A	16 x 1,5	12 x 1,5	42 mm	12 mm	19 mm	17 mm	14 mm	58 g
10 / 8 mm	DLR1008A	16 x 1,5	14 x 1,5	42 mm	12 mm	19 mm	17 mm	17 mm	58 g
12 / 6 mm	DLR1206A	18 x 1,5	12 x 1,5	43 mm	13 mm	22 mm	19 mm	14 mm	63 g
12 / 8 mm	DLR1208A	18 x 1,5	14 x 1,5	43 mm	13 mm	22 mm	19 mm	17 mm	70 g
12 / 10 mm	DLR1210A	18 x 1,5	16 x 1,5	44 mm	14 mm	22 mm	19 mm	19 mm	80 g
15 / 6 mm	DLR1506A	22 x 1,5	12 x 1,5	44 mm	14 mm	27 mm	24 mm	14 mm	100 g
15 / 8 mm	DLR1508A	22 x 1,5	14 x 1,5	44 mm	14 mm	27 mm	24 mm	17 mm	105 g
15 / 10 mm	DLR1510A	22 x 1,5	16 x 1,5	45 mm	15 mm	27 mm	24 mm	19 mm	110 g
15 / 12 mm	DLR1512A	22 x 1,5	18 x 1,5	45 mm	15 mm	27 mm	24 mm	22 mm	132 g
18 / 8 mm	DLR1808A	26 x 1,5	14 x 1,5	46 mm	14 mm	32 mm	27 mm	17 mm	115 g
18 / 10 mm	DLR1810A	26 x 1,5	16 x 1,5	47 mm	15 mm	32 mm	27 mm	19 mm	145 g
18 / 12 mm	DLR1812A	26 x 1,5	18 x 1,5	47 mm	15 mm	32 mm	27 mm	22 mm	175 g
18 / 15 mm	DLR1815A	26 x 1,5	22 x 1,5	48 mm	16 mm	32 mm	27 mm	27 mm	175 g
22 / 12 mm	DLR2212A	30 x 2,0	18 x 1,5	49 mm	17 mm	36 mm	32 mm	22 mm	200 g
22 / 15 mm	DLR2215A	30 x 2,0	22 x 1,5	50 mm	18 mm	36 mm	32 mm	27 mm	220 g
22 / 18 mm	DLR2218A	30 x 2,0	26 x 1,5	51 mm	18 mm	36 mm	32 mm	32 mm	274 g
28 / 10 mm	DLR2810A	36 x 2,0	16 x 1,5	50 mm	18 mm	41 mm	41 mm	19 mm	250 g
28 / 15 mm	DLR2815A	36 x 2,0	22 x 1,5	51 mm	19 mm	41 mm	41 mm	27 mm	296 g
28 / 18 mm	DLR2818A	36 x 2,0	26 x 1,5	52 mm	19 mm	41 mm	41 mm	32 mm	307 g
28 / 22 mm	DLR2822A	36 x 2,0	30 x 2,0	54 mm	21 mm	41 mm	41 mm	36 mm	309 g

HANDVORMONTAGESTUTZEN

Material: gehärteter Werkzeugstahl



DN (D1)	Art.Nr.	M
M6	VMS-006L	12 x 1,5
M8	VMS-008L	14 x 1,5
M10	VMS-010L	16 x 1,5
M12	VMS-012L	18 x 1,5
M15	VMS-015L	22 x 1,5
M18	VMS-018L	26 x 1,5
M22	VMS-022L	30 x 2,0
M28	VMS-028L	36 x 2,0
M35	VMS-035L	45 x 2,0
M42	VMS-042L	52 x 2,0

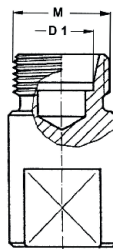

HOCHDRUCK KUGELHAHN

IG/IG

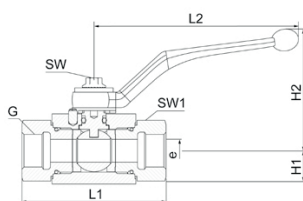

DN (G)	Art.Nr.	PN	H1	H2	L1	L2	SW	SW1	e	Gewicht
1/8"	HOKUR06-1/8	500	13,5 mm	71,5 mm	69 mm	115 mm	9 mm	22 mm	5 mm	410 g
1/4"	HOKUR08-1/4	500	13,5 mm	71,5 mm	69 mm	115 mm	9 mm	22 mm	6 mm	400 g
3/8"	HOKUR10-3/8	500	17,5 mm	72,5 mm	72 mm	115 mm	9 mm	27 mm	10 mm	540 g
1/2"	HOKUR15-1/2	500	19,0 mm	73,0 mm	83 mm	115 mm	9 mm	30 mm	13 mm	650 g
3/4"	HOKUR20-3/4	400	24,5 mm	86,5 mm	95 mm	160 mm	14 mm	41 mm	20 mm	1500 g
1"	HOKUR25-1	315	29,5 mm	89,5 mm	113 mm	160 mm	14 mm	50 mm	25 mm	2200 g

Material: V4A, Dichtung: FKM, Spindeldichtung: PTFE
auf Anfrage auch mit NPT-Gewinde od. Schneidringanschluss

HIGH-TECH-PASTE



ERFORDERLICH!



Füllmenge	Art.Nr.
120g	ZUBEHÖR-H-120
450g	ZUBEHÖR-H-450

ACHTUNG: Für die Montage von Schneidringverschraubungen ist eine Montagepaste (High-Tech-Paste) zu verwenden, ansonsten kann keine Garantie über die Funktion gegeben werden!

ROHRE NAHTLOS

Material: V4A (auch in V2A)
Herstellungslänge: 5 m - 7 m
für Schneidringverschraubungen geeignet



DN
6 x 1
6 x 1,5
8 x 1
8 x 1,5
8 x 2
10 x 1
10 x 1,5
10 x 2
12 x 1,5
12 x 2
12 x 2,5
15 x 1,5
15 x 2
15 x 2,5
18 x 1,5
18 x 2
18 x 2,5
22 x 1,5
22 x 2
22 x 2,5
28 x 2
28 x 2,5
33,7 x 2



GETRÄNKELEITUNGSFITTINGS

- » nach DIN11851
- » lagermäßig in Edelstahl AISI304 verfügbar
- » mit lebensmittelechten Perbunan-Dichtungen ausgestattet
- » die “Milchrrohrverschraubung” ist die weitverbreitetste Rohrverbindungstechnik in lebensmittelverarbeitenden Betrieben
- » in Verbindung mit Getränkeleitungsrohren DIN11850 ist sie eine leicht lösbare und hygienische Verbindungstechnik

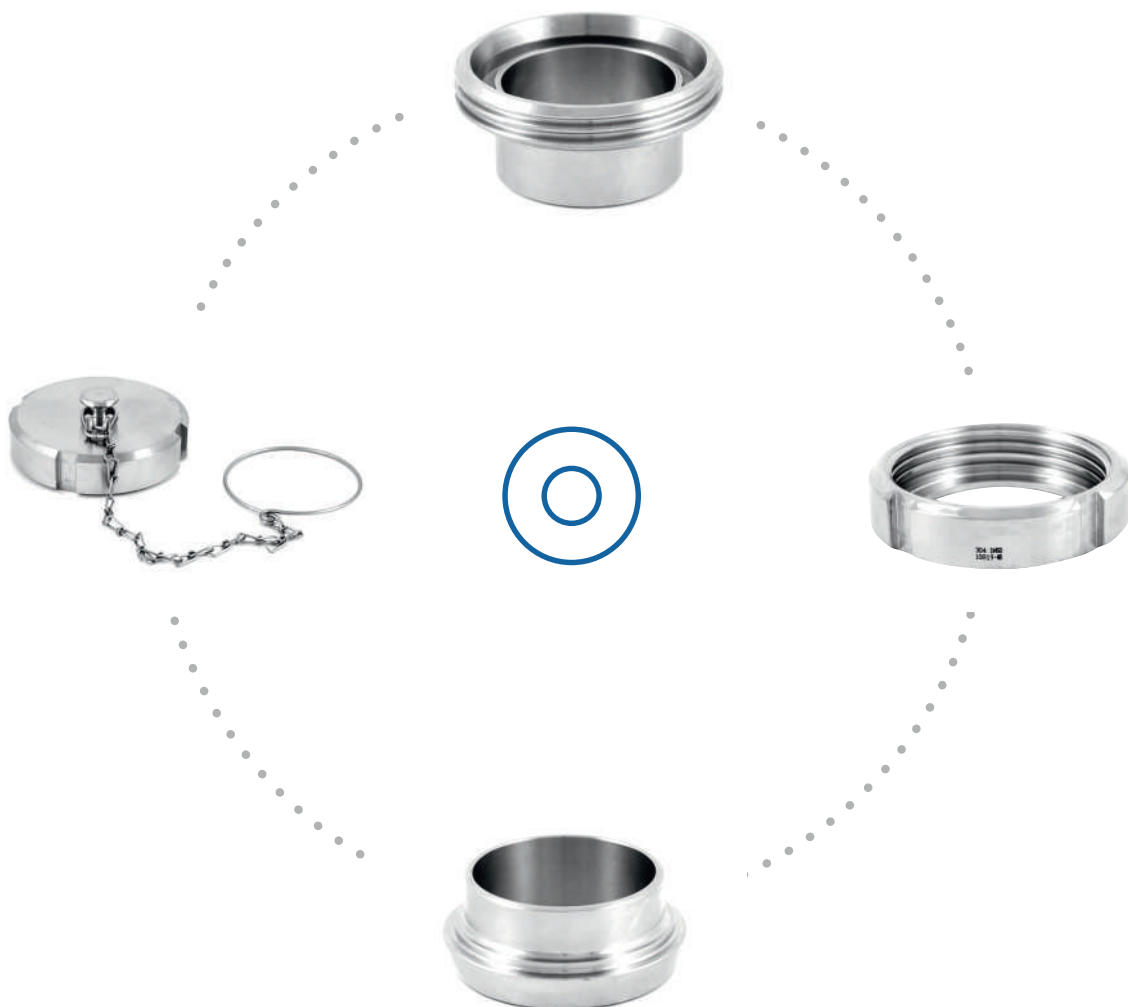

GEWINDESTUTZEN

Material: V2A, DIN 11851



DN	Art.Nr.	A	B	C	H
15	GL-GKS2A-015	16 mm	21 mm	34 mm x 1/8"	21 mm
20	GL-GKS2A-020	20 mm	25 mm	44 mm x 1/6"	24 mm
25	GL-GKS2A-025	26 mm	31 mm	52 mm x 1/6"	29 mm
32	GL-GKS2A-032	32 mm	37 mm	58 mm x 1/6"	32 mm
40	GL-GKS2A-040	38 mm	43 mm	65 mm x 1/6"	33 mm
50	GL-GKS2A-050	50 mm	55 mm	78 mm x 1/6"	35 mm
65	GL-GKS2A-065	66 mm	72 mm	95 mm x 1/6"	40 mm
80	GL-GKS2A-080	81 mm	87 mm	110 mm x 1/6"	45 mm
100	GL-GKS2A-100	100 mm	106 mm	130 mm x 1/6"	54 mm
125	GL-GKS2A-125	125 mm	132 mm	160 mm x 1/6"	46 mm

KEGELSTUTZEN

Material: V2A, DIN 11851



DN	Art.Nr.	A	B	C	H
15	GL-KES2A-015	16 mm	21 mm	28,5 mm	17 mm
20	GL-KES2A-020	20 mm	25 mm	36,5 mm	18 mm
25	GL-KES2A-025	26 mm	31 mm	44,5 mm	22 mm
32	GL-KES2A-032	32 mm	37 mm	50,0 mm	25 mm
40	GL-KES2A-040	38 mm	43 mm	56,0 mm	26 mm
50	GL-KES2A-050	50 mm	55 mm	68,5 mm	28 mm
65	GL-KES2A-065	66 mm	72 mm	86,0 mm	32 mm
80	GL-KES2A-080	81 mm	87 mm	100,0 mm	37 mm
100	GL-KES2A-100	100 mm	106 mm	121,0 mm	44 mm
125	GL-KES2A-125	125 mm	132 mm	150,0 mm	34 mm

NUTMUTTER

Material: V2A, DIN 11851

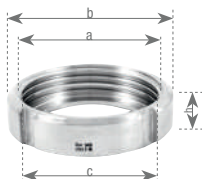

DN	Art.Nr.	A	B	C	H
15	GL-NM2A-015K	25 mm	44 mm	34 mm x 1/8"	18 mm
20	GL-NM2A-020K	31 mm	54 mm	44 mm x 1/6"	21 mm
25	GL-NM2A-025K	36 mm	63 mm	52 mm x 1/6"	21 mm
32	GL-NM2A-032K	42 mm	70 mm	58 mm x 1/6"	21 mm
40	GL-NM2A-040K	49 mm	78 mm	65 mm x 1/6"	21 mm
50	GL-NM2A-050K	62 mm	92 mm	78 mm x 1/6"	22 mm
65	GL-NM2A-065K	80 mm	112 mm	95 mm x 1/6"	25 mm
80	GL-NM2A-080K	94 mm	127 mm	110 mm x 1/6"	29 mm
100	GL-NM2A-100K	115 mm	138 mm	130 mm x 1/6"	31 mm
125	GL-NM2A-125K	138 mm	178 mm	160 mm x 1/6"	35 mm

BLINDMUTTER

Material: V2A, DIN 11851

inkl. Kette

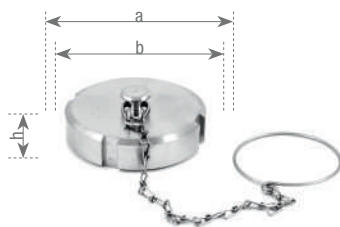

DN	Art.Nr.	A	B	H
15	GL-BM2A-015K	44 mm	34 mm x 1/8"	25 mm
20	GL-BM2A-020K	54 mm	44 mm x 1/6"	28 mm
25	GL-BM2A-025K	63 mm	52 mm x 1/6"	28 mm
32	GL-BM2A-032K	70 mm	58 mm x 1/6"	28 mm
40	GL-BM2A-040K	78 mm	65 mm x 1/6"	28 mm
50	GL-BM2A-050K	92 mm	78 mm x 1/6"	29 mm
65	GL-BM2A-065K	112 mm	95 mm x 1/6"	32 mm
80	GL-BM2A-080K	127 mm	110 mm x 1/4"	36 mm
100	GL-BM2A-100K	148 mm	130 mm x 1/4"	38 mm
125	GL-BM2A-125K	178 mm	160 mm x 1/4"	42 mm

DICHTRING

für Verschraubungen DIN 11851

Material: NBR

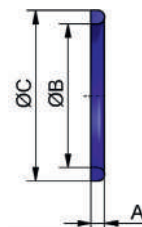

DN	Art.Nr.	A	B	C
15	GL-DR-PERB-015K	4,5 mm	18 mm	26 mm
20	GL-DR-PERB-020K	4,5 mm	23 mm	33 mm
25	GL-DR-PERB-025K	5,0 mm	30 mm	40 mm
32	GL-DR-PERB-032K	5,0 mm	36 mm	46 mm
40	GL-DR-PERB-040K	5,0 mm	42 mm	52 mm

DN	Art.Nr.	A	B	C
50	GL-DR-PERB-050K	5,0 mm	54 mm	64 mm
65	GL-DR-PERB-065K	5,0 mm	71 mm	81 mm
80	GL-DR-PERB-080K	5,0 mm	85 mm	95 mm
100	GL-DR-PERB-100K	6,0 mm	104 mm	114 mm
125	GL-DR-PERB-125K	7,0 mm	130 mm	142 mm

SCHLÄUCHE

- » flexible EPDM-Schläuche für diffusionsoffene Anbindungen
- » maximale Flexibilität und höchste Belastbarkeit
- » flexibel - nicht nur im Einbau sondern auch im Einsatzbereich
- » Vollmetall-Ringwellenschläuche individuell konfektionierbar
- » Aufbau: hochwertige Umflechtung aus Edelstahl, flexibles und mechanisch belastbares EPDM, Standardanschluss Messing vernickelt, Presshülse aus Aluminium



PANZERSCHLÄUCHE

flexibel

Varianten: Mutter x Mutter Art.Nr.: PFMM

DN	Betr.-Druck	Berstdruck
3/4"	15 bar	80 bar
1/2"	15 bar	80 bar
3/4"	10 bar	70 bar
1"	10 bar	60 bar
1 1/4"	10 bar	50 bar
1 1/2"	6 bar	50 bar



Varianten: Mutter x Nippel Art.Nr.: PFMN

DN	Betr.-Druck	Berstdruck
3/4"	15 bar	80 bar
1/2"	15 bar	80 bar
3/4"	10 bar	70 bar
1"	10 bar	60 bar
1 1/4"	10 bar	50 bar
1 1/2"	6 bar	50 bar



Material: EPDM-Liner, Umflechtung: V2A, Überwurfmutter: Messing vernickelt bzw. Nippel Messing, Temp. -20°C bis +90°C

METALLSCHLÄUCHE

für spezielle Anwendungen (z.B. Dampf)

Flexible, druckdichte Metallschläuche mit Wellenprofil und Umflechtung

TECHNISCHE DATEN

- Nennweite: DN6 bis DN300
- Länge: bis 5 m
- Temp. -270°C bis +600°C
- Material: Umflechtung: V2A / V4A
- max. PN250

MÖGLICHE ANSCHLUSSARTEN

- Flanschanschlüsse
- metrisches Gewinde
- konisches Gewinde
- Festflansche
- Losflansche
- Anschweißende
- Schneidringanschluss

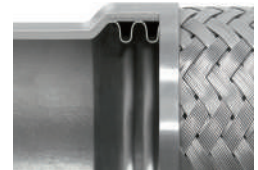
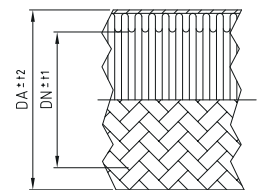

VERSCHIEDENSTE ANSCHLUSSMÖGLICHKEITEN auf Anfrage



Überwurfmutter



Nippel
AG



Überwurfmutter Geträn-
keleitung DIN 11850



Überwurfmutter
flach

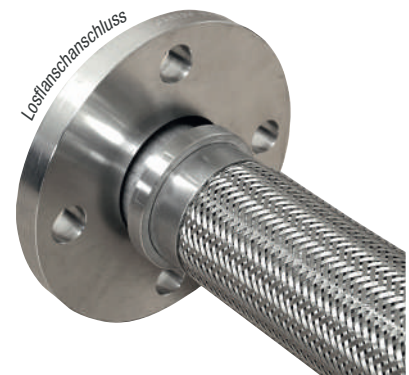

PIPE REPAIR-KIT

- » Zur Notfall-Reparatur defekter und beschädigter Rohre und Leitungen
- » Enthält: WEICON Repair Stick Multi, Reparaturband aus glasfaserverstärktem Kunststoff, Montageanleitung, Schutzhandschuhe
- » Reparaturband 5 cm x 1,5 Meter, 5 cm x 3,5 Meter, 10 cm x 3,5 Meter

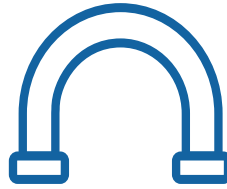



PIPE REPAIR-KIT

hohe Chemikalien und Druckbeständigkeit

Reperaturband	Art.Nr.
5X1,5	ZUBEHÖR-PRK-5/15
5X3,5	ZUBEHÖR-PRK-5/35
10X3,5	ZUBEHÖR-PRK-10/35



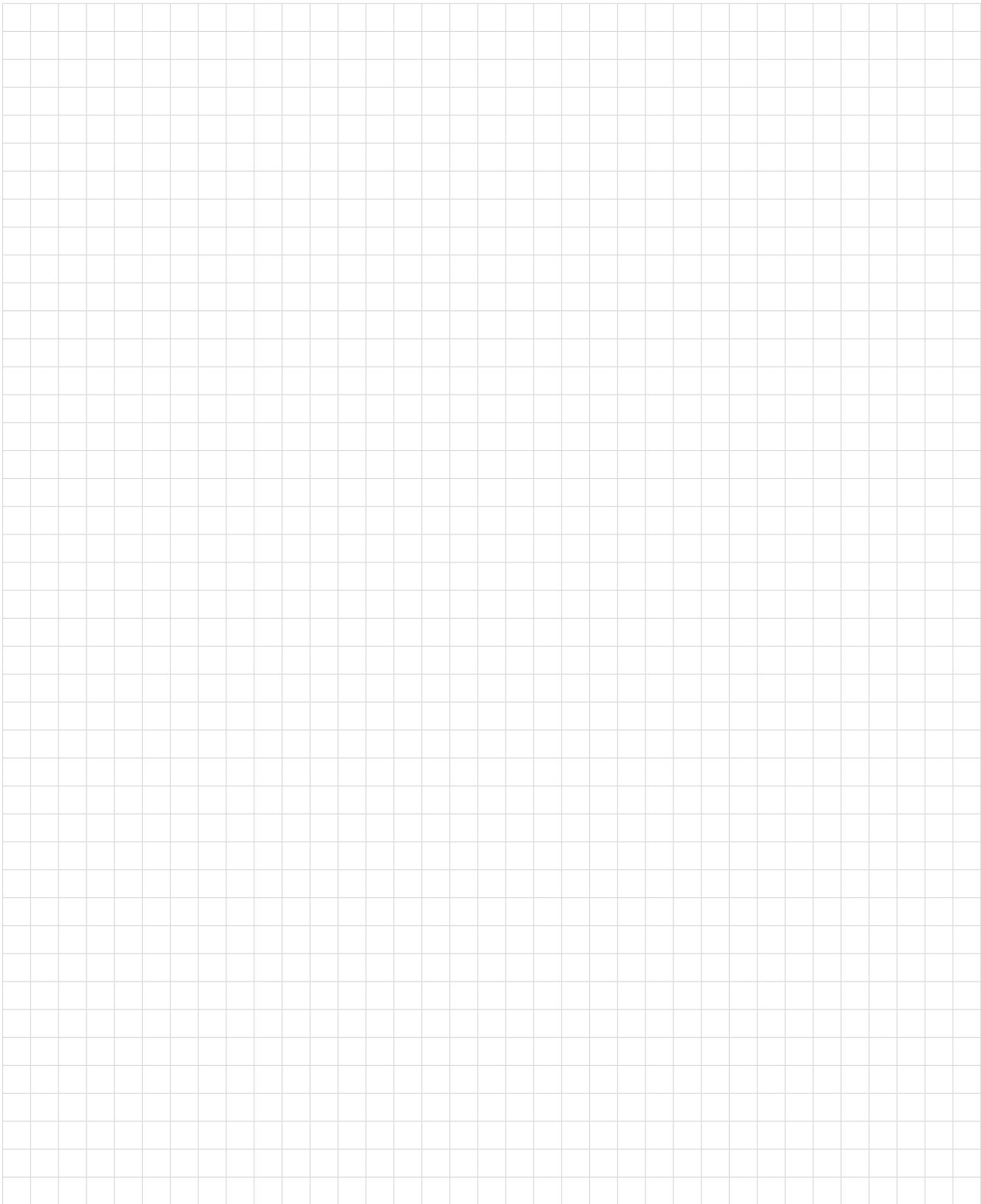

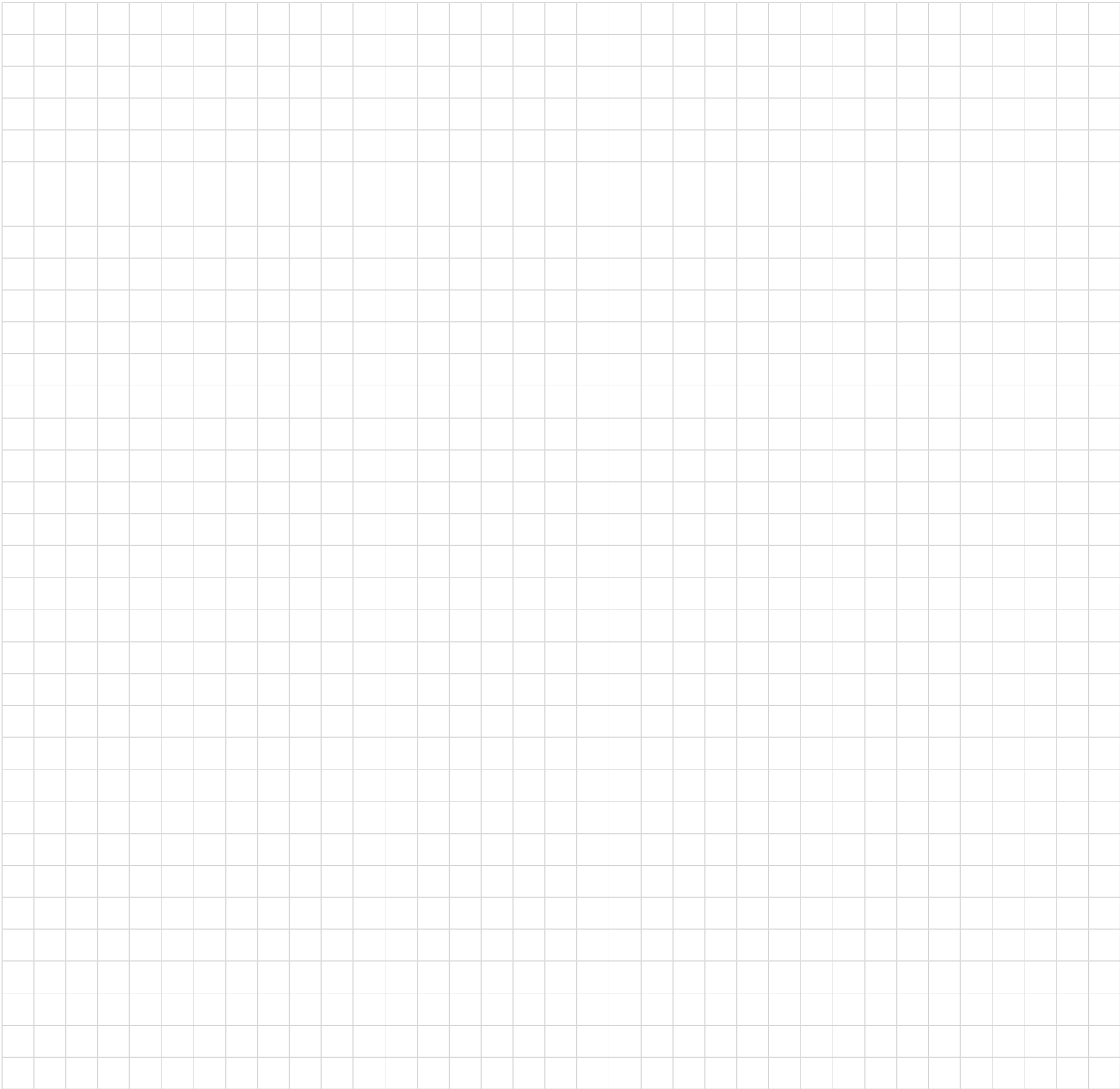

1A Edelstahl GmbH

Geisensheim 6
A- 4632 Pichl bei Wels

Tel.: +43 (0) 7247 / 8778-0
Fax.: +43 (0) 7247 / 8778-40

E-Mail: office@aschl-edelstahl.com
Web: www.aschl-edelstahl.com

*Alle Angaben in diesem Katalog sind ohne Gewähr.
Satz-, Druckfehler sowie Irrtümer vorbehalten.*





Scannen und Katalog anfordern
(<https://www.aschl-edelstahl.com/kontakt-2/>)

ASCHL[®]
EDELSTAHL IN BESTFORM

www.aschl-edelstahl.com